



FUSION  **LAMPS**

PRODUCT GUIDE



Fusion Lamps understands the future of lighting and its product offering reflects it. Check out our wide-ranging product offering of traditional and LED lamps and tubes. WWW.FUSION-LAMPS.COM

Table of Contents

INTRODUCTION

Types of LED Lamps	2-3
--------------------------	-----

PRODUCTS

Lamp Holders	4
Ballast	5
Incandescent	6
Halogen	6
Compact Fluorescent	6-7
Fluorescent Tube	7-8
High Pressure Sodium	8
Metal Halide	9
LED.....	9-16
Sensor & Remote	16

INSTALLATION INSTRUCTIONS

LED Corn Light V4	19-20
LED C/W Selectable Corn Light	21-23
LED Area Light.....	24-27
High-Bay Retro.....	28
Single Ended Bypass.....	29-30
Double Ended Bypass	31-34
Type A+B LED T8 Tube Light.....	35-36

Types of LED Lamps

1. TYPE A - Easiest Installation

LED Tube with Integrated Driver – Compatible and Operated on Existing LFL Ballast:

Description: This UL Type A tube, is designed with an internal driver that allows the tube to operate directly from the existing linear fluorescent ballast. Most of these products are designed to work with T12, T8 and T5 ballasts.

Commonly called:
Direct
Plug & play

ADVANTAGES: UL Type A offers the simplest installation process— retrofitting involves a simple swap of the existing LFL with a UL Type A LED tube. Unlike the other options, no electrical or structural modification of the existing LFL fixture is required. **Note:** Check ballast compatibility for Type A.

2. TYPE B - Simplest Total System

Ballast Bypass LED Tube – Wired to Mains:

Description: Like the UL Type A, this UL Type B tube operates with an internal driver. However, UL Type B's internal driver is powered directly from the main voltage supplied to the existing LFL fixture, requiring several important and unique considerations.

It is important to note that the fixture's incoming power wires are connected directly to the sockets, meaning installers are potentially exposed to the main's voltage during installation. For replacement safety reasons, strict adherence to installation instructions is critical when rewiring existing fixtures and utilizing UL Type B tubes. Safe installation can be completed, but total installation time and cost will increase because of additional precautions required.

Commonly called:
Direct wire
bypass
Single ended wiring
Double ended wiring
Type A and Type B

ADVANTAGES: UL Type B offers the simplest total system— retrofitting involves wiring directly to main voltage, bypassing the ballast which removes any compatibility issues, as well as eliminating maintenance costs associated with ballast replacements.



DUAL MODE INTERNAL DRIVER (UL Type A and Type B)

Dual Mode Internal Driver (UL Type A and Type B):

Description: U-bend, Four-foot or two-foot LED “tubes” designed to replace U-bend four-foot or two-foot fluorescent lamps, respectively. Products in this category have the ability to operate off the existing fluorescent ballast and also have the ability to operate off of line voltage if the fixture is rewired to bypass the ballast. These products connect to the fixture using standard pin-base connections to the lamp holders. Note that due to testing considerations, at this time only products that can operate off specific ballasts types are eligible.

3. TYPE C - Best Performance

LED Tube with Remote Driver:

Description: A UL Type C tube, offered as the LED Tube with remote driver, operates with a remote driver that powers the LED linear tube, rather than an integrated driver. Like UL Type B, UL Type C involves electrical modification to the existing fixture, but the low-voltage outputs of the driver are connected to the sockets instead of line voltage.

ADVANTAGES: Installation for UL Type C tubes involves removing existing tubes and ballasts, and it may involve replacement of existing sockets if damaged. The fixture input wires must be connected to the LED driver, and the driver's low-voltage output wires must then be connected to the sockets before installing the new LED linear tubes. Once installed, this driver can power several LED tubes throughout the fixture. The UL Type C offers excellent system efficacy, best system compatibility, and greatest overall performance. It can be integrated with robust dimming and control functionality, helping to offset moderate labor and installation costs with heightened efficiency well into the future.

UL Considerations

If retrofitting an existing fixture that is UL approved with a UL-approved LED tube, the fixture will remain UL approved. If retrofitting an existing fixture that is not UL approved with a UL-approved LED tube, the fixture with the LED tubes would need to be submitted to UL for approval if UL certification is necessary.

Lamp Holders



FLHT8SPNS



FLHT8SSPNS



FLHT8TPNS



FLHT8TPS



FLHT8UWLNS



FLHT8UWLS



FLHT8WLNS



FLHT8WLS



FLHT5



FLHT8HOF



FLHT8HOS



FLHT8NS



FLHT8S



FLHT8SNS



FLHT8SS



FMMA



FMMR

BALLAST



PART #	STOCK CODE	DESCRIPTION	BOX QTY
ELECTRONIC BALLAST SERIES			
FB232MVE	0276-7119	FUSION 32W 2L T8 120/277V ELECTRONIC	1/10
FB254T5MVE	0276-7131	FUSION 54W 2L T5 120/277V ELECTRONIC	1/10
FB259T8MVE	0276-7137	FUSION 59W 2L T8 120/277V ELECTRONIC	1/10
FB2H096MV	0276-7149	FUSION 110W 2L T12 F96 HO ELECTRONIC	1/10
FB332MVE	0280-3515	FUSION 32W T8 120-277 ELECTRONIC	1/10
FB432MVE	0276-7152	FUSION 32W 4L T8 120/277V ELECTRONIC IS2/3 LAMP	1/10
FB454T5MVE	0276-7155	FUSION 54W 4L T5 120/277V ELECTRONIC	1/10

LAMP HOLDERS



PART #	STOCK CODE	DESCRIPTION	BOX QTY
LAMP HOLDERS & SOCKETS SERIES			
FLHT8SNS	0542-1981	T8 SHORT SNAP-IN SOCKET NON-SHUNTE	1
FLHT8SS	0542-3424	T8 SHORT SNAP-IN SOCKET SHUNTED	1
FLHT8NS	0299-3643	T8 MED SNAP-IN LAMP HOLDER SOCKET NON-SHUNTE	1
FLHT8S	0299-3646	T8 MED SNAP-IN LAMP HOLDER SOCKET SHUNTED	1
FLHT5	0299-3649	T5 LAMPHOLDER	1
FLHT5SNS	0586-4616	T5 SPRING LOAD NON-SHUNTED	1
FLHT5FNS	0586-4619	T5 FIXED NON-SHUNTED	1
FLHT8UWLS	0299-3652	T8 U LAMP HOLDER SHUNTED	1
FLHT8UWLNS	0539-4420	T8 U LAMP HOLDER NON-SHUNTED	1
FLHT8WLS	0542-3409	T8 LAMP HOLDER FOR WRAP LIGHT SHUNTED	1
FLHT8WLNS	0538-9800	T8 LAMP HOLDER FOR WRAP LIGHT UN-SHUNTED	1
FLHT8TPNS	0299-3655	T8 LAMP HOLDER TALL PROFILE 23.5MM NON-S	1
FLHT8TPS	0299-3658	T8 LAMP HOLDER TALL PROFILE 23.5MM SHUNT	1
FLHT8HOF	0539-4384	T8 HO LAMP HOLDER FIXED	1
FLHT8HOS	0539-4381	T8 HO LAMP HOLDER SPRING LOAD	1
FLHT8SPNS	0538-7808	T8 FIXED SINGLE PIN LAMP HOLDER	1
FLHT8SSPNS	0538-7805	T8 SPRING LOAD SINGLE PIN LAMP HOLDER	1
FMMR	0313-4400	MOG TO MED REDUCER	1
FMME	0544-7745	MOG TO MOG EXTENDER	1
FMMA	0314-7768	MED TO MOG ADAPTOR	1
LED INSTALL KIT SERIES			
FLED T KIT	0289-2846	1 LAMP TOMBSTONE KIT LED READY	1
FLED T KIT 2L	0314-3862	2 LAMP TOMBSTONE KIT LED READY	1
FLED T KIT 3L	0314-3865	3 LAMP TOMBSTONE LIT LED READY	1
FLED T KIT 4L	0314-3868	4 LAMP TOMBSTONE KIT LED READY	1

INCANDESCENT



PART #	STOCK CODE	DESCRIPTION	PACK	LUMENS	CCT	CRI	DIMENSIONS	DIM
INCANDESCENT SERIES								
FI3OR20/FL	0256-2732	R20 30W FL	60	280	3000	100+	4.02" X 2.48"	YES
FI5OR20/FL	0256-2729	R20 50W FL	100	360	3000	100+	4.02" X 2.48"	YES
FI65BR30/FL	0256-2714	BR30 65W FL	50	580	3000	100+	6.5" X 4.92"	YES
FI75BR40/FL	0256-2720	BR40 75W FL	50	600	3000	100+	6.5" X 6.74"	YES

HALOGEN



PART #	STOCK CODE	DESCRIPTION	PACK	LUMENS	CCT	CRI	DIMENSIONS	DIM
ECO HALOGEN SERIES								
FH38PAR20/ECO/FL	0291-6639	38W HALOGEN ECO PAR20 120V FLOOD	15	520	3000	>99	3.14" X 2.48"	YES
FH38PAR30/ECO/FL	0294-0042	38W HALOGEN ECO PAR30 120V FLOOD	15	520	3000	>99	3.58" X 3.78"	YES
FH38PAR30L/ECO/FL	0291-6642	38W HALOGEN ECO PAR30 LONG NECK 120V FLD	15	520	3000	>99	4.72" X 3.78"	YES
FH55PAR30/ECO/FL	0294-0045	55W HALOGEN ECO PAR30 120V FLOOD	15	960	3000	>99	3.58" X 3.78"	YES
FH55PAR30L/ECO/FL	0291-6645	55W HALOGEN ECO PAR30 LONG NECK 120V FLD	15	960	3000	>99	4.72" X 3.78"	YES
FH60PAR38/ECO/FL	0291-6648	60W HALOGEN ECO PAR38 120V FLOOD	15	1080	3000	>99	5.19" X 4.84"	YES
FH70PAR38/ECO/FL	0291-6651	70W HALOGEN ECO PAR38 120V FLOOD	15	1310	3000	>99	5.19" X 4.84"	YES

COMPACT FLUORESCENT



PART #	STOCK CODE	DESCRIPTION	PACK	LUMENS	CCT	CRI	DIMENSIONS	DIM
CFL PL 2-PIN SERIES								
FCF13TT830/2 PIN	0246-7881	CF13W TT 830 GX23 2PIN	50	820	3000	82+	4.3" X 1.04"	YES
FCF26DTT835/2 PIN	0246-7920	CF26W DTT 835 GX240-3 2PIN	50	1800	3500	82+	5.83" X 1.04"	YES
FCF26DTT841/2 PIN	0246-7923	CF26W DTT 841 GX240-3 2PIN	50	1800	4100	82+	5.83" X 1.04"	YES
CFL PL 4-PIN SERIES								
FCF13DTT835/4 PIN	0246-7938	CF 13W DTT 835 GX240-1 4PIN	50	760	3500	82+	3.72" X 1.04"	YES
FCF13DTT841/4 PIN	0246-7941	CF 13W DTT 841 GX240-1 4PIN	50	760	4100	82+	3.72" X 1.04"	YES
FCF18DTT841/4 PIN	0246-7950	CF 18W DTT 841 GX240-2 4PIN	50	760	4100	82+	5.04" X 1.04"	YES
FCF26DTT841/4 PIN	0246-7959	CF 26W DTT 841 GX240-3 4PIN	50	1800	4100	82+	5.83" X 1.04"	YES
FCF26DTT850/4 PIN	0268-1151	CF 26W DTT 850 GX240-3 4PIN	50	1800	5000	82+	5.83" X 1.04"	YES
FCF18TTT830/4 PIN	0246-7962	CF 18W TTT 830 GX240-2 4PIN	50	1200	3000	82+	3.82" X 1.61	YES
FCF18TTT835/4 PIN	0246-7965	CF 18W TTT 835 GX240-2 4PIN	50	1200	3500	82+	3.82" X 1.62	YES
FCF18TTT841/4 PIN	0246-7968	CF 18W TTT 841 GX240-2 4PIN	50	1200	4100	82+	3.82" X 1.63	YES
FCF26TTT830/4 PIN	0246-7971	CF 26W TTT 830 GX240-3 4PIN	50	1800	3000	82+	4.41" X 1.04"	YES
FCF32TTT835/4 PIN	0246-7983	CF 32W TTT 835 GX240-3 4PIN	50	2400	3500	82+	4.92" X 1.61"	YES
FCF32TTT841/4 PIN	0246-7986	CF 32W TTT 841 GX240-3 4PIN	50	2400	4100	82+	4.92" X 1.61"	YES
FCF42TTT830/4 PIN	0246-7989	CF 42W TTT 830 GX240-4 4PIN	50	3200	3000	82+	5.95" X 1.61"	YES
FCF42TTT835/4 PIN	0246-7992	CF 42W TTT 835 GX240-4 4PIN	50	3200	3500	82+	5.95" X 1.61"	YES
FCF42TTT841/4 PIN	0246-7995	CF 42W TTT 841 GX240-4 4PIN	50	3200	4100	82+	5.95" X 1.61"	YES

COMPACT FLUORESCENT



PART #	STOCK CODE	DESCRIPTION	PACK	LUMENS	CCT	CRI	DIMENSIONS	DIM
CFL PLL SERIES								
FCF36PLL841/4P	0279-7485	CF 36W DLL 841 2G11 4PIN	50	2700	4100	82+	16.20" X 1.5"	YES
FCF40PLL841/4P	0275-7369	CF 40W DLL 841 2G11 4PIN	50	3150	4100	82+	21.0" X 1.5"	YES
FCF55PLL835/4P	0279-7494	CF 55W DLL 835 2G11 4PIN	50	4320	3500	82+	21.0" X 1.5"	YES
FCF55PLL841/4P	0275-7372	CF 55W DLL 841 2G11 4PIN	50	4320	4100	82+	21.0" X 1.5"	YES

FLUORESCENT TUBE



PART #	STOCK CODE	DESCRIPTION	PACK	LUMENS	CCT	CRI	DIMENSIONS	DIM
T5 FLUORESCENT TUBE SERIES								
FF8T5/830	0269-5188	8W T5 830 G5 BASE	10	450	3000	82+	12"	YES
FF14T5/841	0275-7375	14W T5 841 G5 BASE	25	1200	4100	82+	22"	YES
FF28T5/835	0275-8044	28W T5 835 G5 BASE	25	2500	3500	82+	33.4"	YES
FF28T5/841	0275-7378	28W T5 841 G5 BASE	25	2500	4100	82+	33.4"	YES
FF54T5/835 HO	0257-9655	54W T5 835 G5 BASE	25	4700	3500	82+	45.8"	YES
FF54T5/841 HO	0252-7980	54W T5 841 G5 BASE	25	4700	4100	82+	45.8"	YES
FF54T5/850 HO	0269-4108	54W T5 850 G5 BASE	25	4560	5000	82+	45.8"	YES
FF54T5/865 HO	0279-9798	54W T5 865 G5 BASE	25	4560	6500	82+	45.8"	YES
T8 FLUORESCENT TUBE 700 SERIES								
FF17T8/735	0246-8061	17W T8 735 G13 BASE	25	1400	3500	82+	24"	YES
T8 FLUORESCENT TUBE 800 SERIES								
FF17T8/830	0246-8067	17W T8 830 G13 BASE	25	1400	3000	82+	24"	YES
FF17T8/835	0246-8070	17W T8 835 G13 BASE	25	1400	3500	82+	24"	YES
FF17T8/841	0246-8073	17W T8 841 G13 BASE	25	1350	4100	82+	24"	YES
FF17T8/850	0256-2753	17W T8 850 G13 BASE	25	1230	5000	82+	24"	YES
FF25T8/830	0246-8085	25W T8 830 G13 BASE 3FT	25	2250	3000	82+	36"	YES
FF25T8/841	0246-8091	25W T8 841 G13 BASE 3FT	25	2250	4100	82+	36"	YES
FF32T8/830	0246-8103	32W T8 830 G13 BASE	25	3100	3000	82+	48"	YES
FF32T8/835	0246-8106	32W T8 835 G13 BASE	25	3100	3500	82+	48"	YES
FF32T8/841	0246-8109	32W T8 841 G13 BASE	25	3100	4100	82+	48"	YES
FF32T8/850	0261-7236	32W T8 850 G13 BASE	25	2775	5000	82+	48"	YES
FF32T8/865	0279-9795	32W T8 865 G13 BASE	25	2950	6500	82+	48"	YES
T8 FLUORESCENT TUBE ES 800 SERIES								
FF25T8/835 4FT	0280-1577	4FT 25W T8 835 ENERGY SAVER	25	3100	3500	82+	48"	YES
FF25T8/850 4FT	0279-9789	4FT 25W T8 850 ENERGY SAVER	25	2950	5000	82+	48"	YES
FF28T8/830 4FT	0280-1580	4FT 28W T8 830 ENERGY SAVER	25	2725	3000	82+	48"	YES
FF28T8/835 4FT	0280-1583	4FT 28W T8 835 ENERGY SAVER	25	2700	3500	82+	48"	YES
FF28T8/850 4FT	0279-9792	4FT 28W T8 850 ENERGY SAVER	25	2650	5000	82+	48"	YES

FLUORESCENT TUBE



PART #	STOCK CODE	DESCRIPTION	PACK	LUMENS	CCT	CRI	DIMENSIONS	DIM
T8 FLUORESCENT TUBE HLO 800 SERIES								
FF32T8/835 HLO	0280-1589	4FT 32W T8 835 HLO ENERGY SAVER	25	3008	3500	82+	48"	YES
FF32T8/841 HLO	0280-1592	4FT 32W T8 841 HLO ENERGY SAVER	25	2961	4100	82+	48"	YES
FF32T8/850 HLO	0280-1595	4FT 32W T8 850 HLO ENERGY SAVER	25	2914	5000	82+	48"	YES
T8 - FLUORESCENT TUBE U-BEND SERIES								
FF32T8/741/U6	0246-8196	32W T8 741 U-TUBE 6" G13 BASE	10	2350	4100	70+	22.50"	YES
FF32T8/835/U6	0293-4759	32W T8 835 U-TUBE 6" G13 BASE	10	2600	3500	85+	22.50"	YES
FF32T8/841/U6	0287-6244	32W T8 841 U-TUBE 6" G13 BASE	10	2600	4100	85+	22.50"	YES
FF32T8/850/U6	0287-6247	32W T8 850 U-TUBE 6" G13 BASE	10	2600	5000	85+	22.50"	YES
T8 XLL FLUORESCENT TUBE SERIES								
FF32T8/835/FP/XLL	0291-5961	32W T8 835 G13 BASE FUSION PRO X LONG LIFE	25	3100	3500	82+	48"	YES
FF32T8/841/FP/XLL	0291-5964	32W T8 841 G13 BASE FUSION PRO X LONG LIFE	25	3100	4100	82+	48"	YES
FF32T8/850/FP/XLL	0291-5967	32W T8 850 G13 BASE FUSION PRO X LONG LIFE	25	3100	5000	82+	48"	YES
FF32T8/865/FP/XLL	0291-5970	32W T8 865 G13 BASE FUSION PRO X LONG LIFE	25	2950	6500	82+	48"	YES

HIGH PRESSURE SODIUM



PART #	STOCK CODE	DESCRIPTION	PACK	LUMENS	CCT	CRI	DIMENSIONS
HIGH PRESSURE SODIUM SERIES							
FHPS70/MED	0246-8277	LU 70W ED17 MED - CLEAR	24	6300	2000	22	5.43"
FHPS100/MOG	0246-8283	LU 100W ED23 MOG - CLEAR	24	9500	2000	22	7.75"
FHPS150/MOG	0246-8286	LU 150W ED23 MOG - CLEAR	12	16000	2000	22	7.76"
FHPS250/MOG	0258-8214	LU 250W ED28 MOG - CLEAR	12	26000	2000	22	9.65"
FHPS400/T15 MOG	0246-8301	LU 400W T15 MOG - CLEAR	12	50000	2000	22	11.06"
FHPS400/MOG	0246-8295	LU400 ED37 MOG - CLEAR	12	47500	2000	22	11.31"

METAL HALIDE



PART #	STOCK CODE	DESCRIPTION	PACK	LUMENS	CCT	CRI	DIMENSIONS
METAL HALIDE SERIES							
FMH50U/MED	0246-8226	MH 50W PS U ED17 MED - CLEAR	12	3400	4200	65	5.43"
FMH70U/MED	0246-8232	MH 70W PS U ED17 MED - CLEAR	12	5600	4200	65	5.43"
FMH100U/MED	0246-8214	MH 100W PS U ED17 MED - CLEAR	12	9000	4200	65	5.43"
FMH150U/MED	0258-8211	MH 150W PS U ED17 MED - CLEAR	12	14000	4200	65	5.43"
FMH175U/MED	0246-8220	MH 175W PS U ED17 MED - CLEAR	12	17000	4200	65	5.43"
FMH175U/MOG	0246-8241	MH 175W U ED28 MOG - CLEAR	12	14000	4200	65	8.31"
FMH250U/MOG	0246-8244	MH 250W U ED28 MOG - CLEAR	12	22000	4200	65	8.31"
FMH400U/ED28/MOG	0246-8247	MH 400W U ED28 MOG - CLEAR	12	32000	4200	65	8.31"
FMH400U/ED37/MOG	0246-8253	MH 400W U ED37 MOG - CLEAR	12	36000	4200	65	11.5"
FMH1000U/BT37	0246-8250	MH 1000W U BT37 MOG - CLEAR	12	110000	4200	65	11.5"
FMH1000U/BT56	0246-8256	MH 1000W U BT56 MOG - CLEAR	6	110000	4200	65	15.38"
FMH1500U/BT56	0255-5700	MH 1500W U BT56 MOG - CLEAR	6	167000	4200	65	15.38"
PULSE START METAL HALIDE SERIES							
FMP100/ED17-P/U/4K/MED	0279-7395	MH 100W PS U ED17 MED - PULSE START	12	5500	4200	65	5.43"
FMP175/ED17/PS/BU/4K/MED	0279-7401	MH 175W PS BU ED17 MED - PULSE START	12	14400	4200	65	5.43"
FMP175/ED28/PS/BU/4K	0279-7404	MH 175W PS BU ED28 MOG - PULSE START	12	17000	4200	65	8.31"
FMP320/ED28/PS/BU/4K	0279-7410	MH 320W PS BU ED28 MOG - PULSE START	12	31000	4200	65	8.31"
FMP360/BT37/BU/4K	0279-7419	MH 360W PS BU BT37 MOG - PULSE START	12	35000	4200	65	11.5"
FMP400/ED37/PS/BU/4K	0279-7425	MH 400W PS BU BT37 MOG - PULSE START	12	33600	4200	65	11.5"

LED TUBES



PART #	STOCK CODE	DESCRIPTION	PACK	LUMENS	CCT	CRI	DIMENSIONS	DIM	DLC	NSF	SHATTER PROOF
FTL CS 3CCT DUAL T8 SERIES											
FTL8T8/CS/DUAL	0581-9712	8W LED T8 G13 CS 2FT DUAL	25	1000	35,40,50K	83+	24"		✓	✓	✓
FTL18T8/CS/DUAL	0581-9718	18W LED T8 G13 CS 4FT DUAL	25	2300	35,40,50K	83+	48"		✓	✓	✓
FTL 3CCT DUAL T8 SERIES											
FTL18T8/850/DUAL	0552-1545	18W LED T8 G13 50K 4FT DUAL	25	2200	5000	83	48"		✓	✓	✓
FTL18T8/840/DUAL	0552-1542	18W LED T8 G13 40K 4FT DUAL	25	2200	4000	83	48"		✓	✓	✓
FTL8T8/840/DUAL	0552-1554	8W LED T8 G13 40K 2FT DUAL	25	1040	4000	83	24"		✓	✓	✓
FTL8T8/850/DUAL	0552-1557	8W LED T8 G13 50K 2FT DUAL	25	1040	5000	83	24"		✓	✓	✓
FLED DIRECT T5 SERIES											
FLED25T5/850/DIRECTV3	0492-3102	25W LED T5 G5 5K DIRECT	25	3500	5000	82	46"				
FLED DOUBLE ENDED BYPASS T5 SERIES											
FLED25T5/840/DEBYPASS	0424-7877	25W T5 LED 840 DE BYPASS	25	3500	4000	82+	46"				
FLED25T5/850/DEBYPASS	0424-7880	25W T5 LED 850 DE BYPASS	25	3500	5000	82+	46"				

LED TUBES



PART #	STOCK CODE	DESCRIPTION	PACK	LUMENS	CCT	CRI	DIMENSIONS	DIM	DLC	NSF	SHATTER PROOF
FLED BYPASS T8 SERIES											
FLED18T8/835/BYPASS	0328-9620	18W LED T8 G13 35K 4FT BYPASS	25	2200	3500	80	48"		✓	✓	
FLED18T8/840/BYPASS	0308-8614	18W LED T8 G13 4K 4FT BYPASS	25	2200	4000	82	48"		✓	✓	
FLED18T8/850/BYPASS	0308-8617	18W LED T8 G13 5K 4FT BYPASS	25	2200	5000	82	48"		✓	✓	
FLED9T8/840/BYPASS	0308-8620	9W LED T8 G13 4K 2FT BYPASS	25	1150	4000	82	24"			✓	
FLED9T8/850/BYPASS	0308-8623	9W LED T8 G13 5K 2FT BYPASS	25	1150	5000	82	24"			✓	
FLED15T8/840/BYPASS	0386-7006	15W LED T8 G13 4K 4FT BYPASS	25	1800	4000	82	48"		✓	✓	
FLED15T8/850/BYPASS	0386-7009	15W LED T8 G13 5K 4FT BYPASS	25	1800	5000	82	48"		✓	✓	
FLED/FDT DOUBLE ENDED BYPASS T8 SERIES											
FDT14T8/840/DEBYPASS	0595-5120	14W LED T8 G13 840 4ft DE BYPASS	25	1800	4000	82	48"		✓		
FDT14T8/850/DEBYPASS	0595-5123	14W LED T8 G13 850 4ft DE BYPASS	25	1800	5000	82	48"		✓		
FDT17T8/840/DEBYPASS	0595-5114	17W LED T8 G13 840 DE BYPASS	25	2200	4000	82	48"		✓		
FDT17T8/850/DEBYPASS	0595-5117	17W LED T8 G13 850 DE BYPASS	25	2200	5000	82	48"		✓		
FTL DOUBLE/SINGLE ENDED BYPASS T8 SERIES											
FTL14T8/840/SD/BYPASS	0580-4616	14W LED T8 G13 840 SINGLE/DE BYPASS	25	1800	4000	80	48"		✓	✓	
FTL14T8/850/SD/BYPASS	0580-4622	14W LED T8 G13 850 SINGLE/DE BYPASS	25	1800	5000	80	48"		✓	✓	
FTL18.5T8/840/SD/BYPASS	0580-4631	18.5W LED T8 G13 840 SINGLE/DE BYPASS	25	2600	4000	80	48"		✓	✓	
FTL18.5T8/850/SD/BYPASS	0580-4634	18.5W LED T8 G13 850 SINGLE/DE BYPASS	25	2600	5000	80	48"		✓	✓	
FTL SCCT DOUBLE/SINGLE ENDED BYPASS T8 SERIES											
FTL8T8/CS/SD/BYPASS	0595-3473	8W T8 2FT LED G13 SCCT SINGLE-DOUBLE END	25	1000	3K,35K,4K,5K 65K	83	24"		✓	✓	
FTL12T8/CS/SD/BYPASS	0607-5801	12W T8 3FT LED G13 SCCT SINGLE-DOUBLE END	25	1500	3K,35K,4K,5K 65K	83	36"		✓	✓	
FTL15T8/CS/SD/BYPASS	0595-3476	15W T8 4FT LED G13 SCCT SINGLE-DOUBLE END	25	1950	3K,35K,4K,5K 65K	83	48"		✓	✓	
FTL18T8/CS/SD/BYPASS	0595-3479	18W T8 4FT LED G13 SCCT SINGLE-DOUBLE END	25	2250	3K,35K,4K,5K 65K	83	48"		✓	✓	

LED TUBES



PART #	STOCK CODE	DESCRIPTION	PACK	LUMENS	CCT	CRI	DIMENSIONS	DIM	DLC	NSF	SHATTER PROOF
FLED U-TUBE SERIES											
FLED18T8UTUBE/4K/BYPASS	0389-2602	18W LED UBEND 2G13 4K BYPASS	12	2200	4000	82	22"				
FLED18T8UTUBE/5K/BYPASS	0389-2605	18W LED UBEND 2G13 5K BYPASS	12	2200	5000	82	22"				

LED TUBES



PART #	STOCK CODE	DESCRIPTION	PACK	LUMENS	CCT	CRI	DIMENSIONS	DIM	DLC	NSF	SHATTER PROOF
FTL U-TUBE 3CCT DUAL SERIES											
FTL15T8UTUBE/CS/DUAL	0613-5336	15W LED T8 UTUBE 2G13 3 CCT DUAL	20	1950	35,40,50K	80	22"				

LED TUBES



PART #	STOCK CODE	DESCRIPTION	PACK	LUMENS	CCT	CRI	DIMENSIONS	DIM	DLC	NSF	SHATTER PROOF
FLED DOUBLE ENDED BYPASS T8 8FT SERIES											
FTL40T8FA8/840/DEBYPASS	0567-3201	40W LED T8 FA8 4K 8FT D/E BYPASS	10	5500	4000	80	96"		✓	✓	
FTL40T8FA8/850/DEBYPASS	0567-3204	40W LED T8 FA8 5K 8FT D/E BYPASS	10	5500	5000	80	96"		✓	✓	
FTL40T8R17D/840/DEBYPASS	0567-3210	40W LED T8 R17D 4K 8FT D/E BYPASS	10	5500	4000	80	96"			✓	
FTL40T8R17D/850/DEBYPASS	0567-3213	40W LED T8 R17D 5K 8FT D/E BYPASS	10	5500	5000	80	96"			✓	
FTL CS 5CCT DOUBLE ENDED BYPASS 8FT T8 SERIES											
FTL42T8/CS/DEBYPASS	0609-2580	42W T8 8FT LED G13 5CCT DOUBLE END	20	5000	3,35,40,50,65K	83	96"		✓	✓	✓

LED PAR20



PART #	STOCK CODE	DESCRIPTION	PACK	LUMENS	CCT	CRI	DIMENSIONS	DIM	DLC	WET LOCATION RATED	SHATTER PROOF
FL PAR20 SERIES											
FL6.5PAR20927	0591-9483	6.5W LED PAR20 927 DIM	60	500	2700	>90	3.19" x 2.48"	✓		✓	
FL6.5PAR20930	0591-9489	6.5W LED PAR20 930 DIM	60	500	3000	>90	3.19" x 2.48"	✓		✓	
FL6.5PAR20940	0591-9492	6.5W LED PAR20 940 DIM	60	500	4000	>90	3.19" x 2.48"	✓		✓	
FL6.5PAR20950	0591-9495	6.5W LED PAR20 950 DIM	60	500	5000	>90	3.19" x 2.48"	✓		✓	

LED PAR30



PART #	STOCK CODE	DESCRIPTION	PACK	LUMENS	CCT	CRI	DIMENSIONS	DIM	DLC	WET LOCATION RATED	SHATTER PROOF
FL WET LOCATION PAR30 SERIES											
FL8PAR30LN927	0591-9813	8W LED PAR30 LN 927 DIM	24	800	2700	>90	4.33" x 3.62"	✓		✓	
FL8PAR30LN930	0591-9819	8W LED PAR30 LN 930 DIM	24	800	3000	>90	4.33" x 3.62"	✓		✓	
FL8PAR30LN940	0591-9822	8W LED PAR30 LN 940 DIM	24	800	4000	>90	4.33" x 3.62"	✓		✓	
FL8PAR30LN950	0591-9825	8W LED PAR30 LN 950 DIM	24	800	5000	>90	4.33" x 3.62"	✓		✓	
FL PAR30 SERIES											
FL8PAR30SN927	0591-9789	8W LED PAR30 SN 927 DIM	24	800	2700	>90	3.31" x 3.62"	✓		✓	
FL8PAR30SN930	0591-9792	8W LED PAR30 SN 930 DIM	24	800	3000	>90	3.31" x 3.62"	✓		✓	
FL8PAR30SN940	0591-9795	8W LED PAR30 SN 940 DIM	24	800	4000	>90	3.31" x 3.62"	✓		✓	
FL8PAR30SN950	0591-9798	8W LED PAR30 SN 950 DIM	24	800	5000	>90	3.31" x 3.62"	✓		✓	

LED PAR38



PART #	STOCK CODE	DESCRIPTION	PACK	LUMENS	CCT	CRI	DIMENSIONS	DIM	DLC	WET LOCATION RATED	SHATTER PROOF
FL WET LOCATION PAR38 SERIES											
FL13PAR38927	0591-9828	13W LED PAR38 927 DIM	24	1200	2700	>90	5.08" x 4.57"	✓		✓	
FL13PAR38930	0591-9831	13W LED PAR38 930 DIM	24	1200	3000	>90	5.08" x 4.57"	✓		✓	
FL13PAR38940	0591-9834	13W LED PAR38 940 DIM	24	1200	4000	>90	5.08" x 4.57"	✓		✓	
FL13PAR38950	0591-9837	13W LED PAR38 950 DIM	24	1200	5000	>90	5.08" x 4.57"	✓		✓	

LED BR30



PART #	STOCK CODE	DESCRIPTION	PACK	LUMENS	CCT	CRI	DIMENSIONS	DIM	DLC	NSF	SHATTER PROOF
FL BR30 SERIES											
FL8BR30827	0582-6237	8W LED BR30 827 DIM	50	650	2700	80	5.21"x3.75"	✓			
FL8BR30840	0582-6243	8W LED BR30 840 DIM	50	650	4000	80	5.21"x3.75"	✓			
FL8.5BR30827	0582-7413	8.5W LED BR30 827 DIM	40	650	2700	80	5.50"x3.80"	✓			
FL8.5BR30830	0582-7416	8.5W LED BR30 830 DIM	40	650	3000	80	5.50"x3.80"	✓			
FL8.5BR30840	0582-7419	8.5W LED BR30 840 DIM	40	650	4000	80	5.50"x3.80"	✓			
FL8.5BR30850	0582-7422	8.5W LED BR30 850 DIM	40	650	5000	80	5.50"x3.80"	✓			

LED BR40



PART #	STOCK CODE	DESCRIPTION	PACK	LUMENS	CCT	CRI	DIMENSIONS	DIM	DLC	WET LOCATION RATED	SHATTER PROOF
FL BR40 SERIES											
FL15BR40827	0583-8090	15W LED BR40 827 DIM	24	1100	2700	80	6.26" x 4.92"	✓			
FL15BR40830	0583-8093	15W LED BR40 830 DIM	24	1100	3000	80	6.26" x 4.92"	✓			
FL15BR40840	0583-8096	15W LED BR40 840 DIM	24	1100	4000	80	6.26" x 4.92"	✓			
FL15BR40850	0583-8099	15W LED BR40 850 DIM	24	1100	5000	80	6.26" x 4.92"	✓			

LED R20



PART #	STOCK CODE	DESCRIPTION	PACK	LUMENS	CCT	CRI	DIMENSIONS	DIM	DLC	NSF	SHATTER PROOF
FLED R20 SERIES											
FLED7.5R20827	0446-0649	7.5W LED R20 827 DIM	24	525	2700	80	3.74" x 2.48"	✓			
FLED7.5R20830	0446-0652	7.5W LED R20 830 DIM	24	525	3000	80	3.74" x 2.48"	✓			
FLED7.5R20840	0446-0655	7.5W LED R20 840 DIM	24	525	4000	80	3.74" x 2.48"	✓			
FLED7.5R20850	0446-0658	7.5W LED R20 850 DIM	24	525	5000	80	3.74" x 2.48"	✓			

LED MR16



PART #	STOCK CODE	DESCRIPTION	PACK	LUMENS	CCT	CRI	DIMENSIONS	DIM	DLC	NSF	SHATTER PROOF
FLED MR16 SERIES											
FLED6MR16830V2	0493-0728	6W MR16 LED DIM 830	60	420	3000	80	1.90" x 1.97"	✓			

LED CORNCOB



PART #	STOCK CODE	DESCRIPTION	PACK	LUMENS	CCT	CRI	DIMENSIONS	DIM	DLC	MIN ENCLOSURE SIZE	HID EQUIVALENT
FLED HID SERIES											
FLED15HID/5K/MEDV4	0540-4206	15W LED HID 5K MED	24	2100	5000	>80	5.71"x2.56"			(L)12.2" x (W)7.5" x (D)7.5"	60w
FLED19HID/5K/MEDV4	0540-4215	19W LED HID 5K MED	24	2660	5000	>80	6.1"x2.56"			(L)12.6" x (W)7.5" x (D)7.5"	70w
FLED27HID/5K/MEDV4	0540-4242	27W LED HID 5K MED	12	3780	5000	>80	7.8"x3.43"			(L)13.4" x (W)7.9" x (D)7.9"	100w
FLED27HID/5K/MOGV4	0540-4245	27W LED HID 5K MED	12	3240	5000	>80	8.5"x3.43"			(L)13.4" x (W)7.9" x (D)7.9"	100w
FLED36HID/5K/MEDV4	0540-4218	36W LED HID 5K MED	12	5040	5000	>80	8.82"x3.43"			(L)15" x (W)7.9" x (D)7.9"	150w
FLED36HID/5K/MOGV4	0540-4221	36W LED HID 5K MOG	12	4320	5000	>80	9.53"x3.43"			(L)15" x (W)7.9" x (D)7.9"	150w
FLED54HID/5K/MOGV4	0540-4230	54W LED HID 5K MOG	12	6480	5000	>80	10.71"x5.12"			(L)16.5" x (W)7.5" x (D)7.5"	175w
FLED80HID/5K/MOGV4	0540-4233	80W LED HID 5K MOG	6	9600	5000	>80	10.71"x5.12"			(L)16.5" x (W)9.1" x (D)9.1"	250w
FLED100HID/5K/MOGV4	0540-4236	100W LED HID 5K MOG	6	12000	5000	>80	11.38"x5.12"			(L)17.3" x (W)9.4" x (D)9.4"	400w
FLED125HID/5K/MOG	0540-4239	125W LEDHID 5K MOG	6	17500	5000	>80	12.36" x 5.12"			(L)17.3" x (W)10.2" x (D)10.2"	500w
FL HID WS/CS SERIES											
FL27/HID/WSCS/MED	0553-0728	27W LEDHID WS 12W-18W CS 3K-4K-5K MED	24	4185	3,40,50K	>80	6.81"x2.36"			(L)13.4" x (W)7.9" x (D)7.9"	100w
FL27/HID/WSCS/MOG	0553-0731	27W LEDHID WS 12W-18W CS 3K-4K-5K MOG	24	4185	3,40,50K	>80	7.32"x2.36"		✓	(L)13.4" x (W)7.9" x (D)7.9"	100w
FL45/HID/WSCS/MED	0553-0734	45W LEDHID WS 27W-36W CS 3K-4K-5K MED	12	6975	3,40,50K	>80	9.09"x3.35"			(L)16.5" x (W)8.3" x (D)8.3"	175w
FL45/HID/WSCS/MOG	0553-0737	45W LEDHID WS 27W-36W CS 3K-4K-5K MOG	12	6975	3,40,50K	>80	9.84"x3.35"		✓	(L)16.5" x (W)8.3" x (D)8.3"	175w
FL63/HID/WSCS/MOG	0553-0743	63W LEDHID WS 36W-54W CS 3K-4K-5K MOG	12	9765	3,40,50K	>80	10.51"x3.35"		✓	(L)16.5" x (W)9.1" x (D)9.1"	250w
FL100/HID/WSCS/SO/MOG	0553-3566	100W LEDHID WS 63W-80W CS 3K-4K-5K SO OPTION MOG	6	15500	3,40,50K	>80	11"x5.12"		✓	(L)17.3" x (W)9.4" x (D)9.4"	400w

LED PL



PART #	STOCK CODE	DESCRIPTION	PACK	LUMENS	CCT	CRI	DIMENSIONS	DIM	DLC	NSF	SHATTER PROOF
FLED PL SERIES											
FLED12/PL/840/H2PIN	0491-7921	12W LED PL DUAL 840 HOR 2P G24D	48	1200	4000	>80	5.75"x1.34"				
FLED12/PL/835/V2PIN	0491-7924	12W LED PL DUAL 835 VERT 2P G24D	48	1200	3500	>80	4.79"x1.90"				
FLED12/PL/840/V2PIN	0491-7927	12W LED PL DUAL 840 VERT 2P G24D	48	1200	4000	>80	4.79"x1.90"				
FLED12/PL/840/H4PIN	0491-7933	12W LED PL 840 HOR 4P G240/GX240	48	1200	4000	>80	5.75"x1.34"				
FLED12/PL/835/V4PIN	0491-7939	12W LED PL 835 VERT 4P G240/GX240	48	1200	3500	>80	4.79"x1.90"				
FLED12/PL/840/V4PIN	0491-7942	12W LED PL 840 VERT 4P G240/GX240	48	1200	4000	>80	4.79"x1.90"				

LED A19



PART #	STOCK CODE	DESCRIPTION	PACK	LUMENS	CCT	CRI	DIMENSIONS	DIM	DLC	NSF	SHATTER PROOF
FL A19 OMNI DIMMABLE ES SERIES											
FL9A19827	0582-4455	9W LED A19 OMNI 827 DIM	100	800	2700	80	2.40"x4.45"	✓			
FL9A19830	0582-4458	9W LED A19 OMNI 830 DIM	100	800	3000	80	2.40"x4.45"	✓			
FL9A19840	0582-4464	9W LED A19 OMNI 840 DIM	100	800	4000	80	2.40"x4.45"	✓			
FL9A19850	0582-4467	9W LED A19 OMNI 850 DIM	100	800	5000	80	2.40"x4.45"	✓			
FL A19 NON DIM SERIES											
FL9A19827ND	0582-4473	9W LED A19 830 NON DIM	100	800	2700	80	2.40"x4.45"				
FL9A19830ND	0582-4476	9W LED A19 840 NON DIM	100	800	3000	80	2.40"x4.45"				
FL9A19840ND	0582-4479	9W LED A19 850 NON DIM	100	800	4000	80	2.40"x4.45"				
FL9A19850ND	0582-4482	9W LED A19 850 NON DIM	100	800	5000	80	2.40"x4.45"				

LED A21



PART #	STOCK CODE	DESCRIPTION	PACK	LUMENS	CCT	CRI	DIMENSIONS	DIM	DLC	NSF	SHATTER PROOF
FL A21 DIM SERIES											
FL15A21827	0582-5283	15W LED A21 827 DIM	100	1600	2700	80	4.80"x2.60"	✓			
FL15A21830	0582-5286	15W LED A21 830 DIM	100	1600	3000	80	4.80"x2.60"	✓			
FL15A21840	0582-5289	15W LED A21 840 DIM	100	1600	4000	80	4.80"x2.60"	✓			
FL15A21850	0582-5295	15W LED A21 850 DIM	100	1600	5000	80	4.80"x2.60"	✓			

LED FILAMENTS



PART #	STOCK CODE	DESCRIPTION	PACK	LUMENS	CCT	CRI	DIMENSIONS	DIM	DLC	NSF	SHATTER PROOF
FLED FILAMENT SERIES											
FLED4.5B10CAND827C	0549-3873	4.5W B10 CAND DIM 827 CLEAR	24	330	2700	80	3.64"x1.26"	✓			40w
FLED4.5B10MED827C	0527-7690	4W B10 MED DIM 827 CLEAR	24	330	2700	80	3.64"x1.26"	✓			40w
FLED7.5A19827C	0316-2915	7.5W A19 DIM 827 CLEAR	24	800	2700	80	4.01"x2.40"	✓			60w
FLED5.5ST19724A	0316-2918	5W ST19 DIM 724 AMBER	12	380	2400/amber	80	5.67"x2.52"	✓			40w
FLED4.9G25827C	0391-2471	4.9W G25 DIM 827 CLEAR	12	450	2700	>80	5"x3"	✓			40w
FLF32/ED28/CL/5K	0609-2043	32W 120-277V FILAMENT ED28 CLEAR 5K E39		5000	5000	>80	9.2"x3.5"			✓	175W
FLF36/ED28/CL/5K	0609-2046	36W 120-277V FILAMENT ED28 CLEAR 5K E39		6000	5000	>80	9.2"x3.5"			✓	200W
FLF45/ED28/CL/5K	0609-2049	45W 120-277V FILAMENT ED28 CLEAR 5K E39		7500	5000	>80	9.2"x3.5"			✓	250W

LED HIGHBAY



PART #	STOCK CODE	DESCRIPTION	PACK	LUMENS	CCT	CRI	DIMEN- SIONS	DIM	DLC	NOT ENCLOSURE RATED	HID EQUIVALENT
FLED/FL HIGHBAY RETRO SERIES											
FLED80HBR/SO/5K	0538-9857	80W LEDHID 5K MOG/ SENSOR OPTION	4	11200	5000	>80	7.4"x7.9"		✓	✓	250w
FLED100HBR/SO/5K	0550-5897	100W LEDHID 5K MOG/ SENSOR OPTION	4	14000	5000	>80	7.6"x9.1"		✓	✓	300w
FLED120HBR/SO/5K	0550-5900	120W LEDHID 5K MOG/ SENSOR OPTION	4	16800	5000	>80	7.6"x9.1"		✓	✓	400w
FL155HBR/5K	0582-4008	155W LED HIGHBAY RETRO 5K EX39	4	21700	5000	>80	8.96"x8.9"		✓	(L)11.81" X (W) 11.81"	400w
FL200HBR/5K	0582-5733	200W LED HIGHBAY RETRO 5K EX39	4	28000	5000	>80	8.96"x8.9"		✓	(L)11.81" X (W) 11.81"	600w

LED AREA LIGHT



PART #	STOCK CODE	DESCRIPTION	PACK	LUMENS	CCT	CRI	DIMEN- SIONS	DIM	DLC	MIN ENCLOSURE SIZE	HID EQUIVALENT
FL AREA LIGHT SERIES											
FL75AR/5K/SO/MOG	0579-8781	75W LED AREAS LIGHT 5K MOG SENSOR OPT	6	11250	5000	>80	8.74"x4.33"		✓	(16.54")x(9.05") x(9.05")	250w
FL110AR/5K/SO/MOG	0579-8784	110W LED AREAS LIGHT 5K MOG SENSOR OPT	6	16500	5000	>80	11.5"x4.33"		✓	(17.32")x(10.23") x(10.23")	400w

LED CAPSULE



PART #	STOCK CODE	DESCRIPTION	PACK
LED CAPSULE			
FLED4.569CAP/3K/CLR	0550-6212	4.5W G9 CAPSULE 3K CLEAR	1/500
FLED3G4CAP/3K/CLR	0550-6467	3W G4 CAPSULE 3K CLEAR	1/250

SENSORS AND REMOTE



PART #	STOCK CODE	DESCRIPTION	PACK
LED CAPSULE			
FMIC SENSOR	0538-9905	MICROWAVE SENSOR FOR HBR/HID SERIES	1/150
FPIR SENSOR	0550-6632	PIR SENSOR FOR HBR/HID SERIES	1/150
FSENSOR REMOTE	0551-5149	SENSOR REMOTE FOR HBR/HID SERIES	1/100

Sensors are compatible with the following LED lamps.
C/W CORN COBS
FL100/HID/WSCS/SO/MOG • 0553-3566

HIGH-BAY RETRO FIT
FLED80HBR/SO/5K • 0538-9857
FLED100HBR/SO/5K • 0550-5897
FLED120HBR/SO/5K • 0550-5900

AREA LAMP RETO FIT
FL75AR/5K/SO/MOG • 0579-8781
FL110AR/5K/SO/MOG • 0579-8784



Installation Guides & Warnings

Installation Instructions

In this section you will find helpful installation guides, wiring instructions, and suggested application for the products shown on the following pages.

LED Corn Light V4

LED Corn Color/Wattage Selectable

LED Area Light Retro-fit

High-Bay Retro

Single Ended By Pass/Line Voltage

Double Ended By Pass/Line Voltage

Type A+B LED T8 Tube Light



LED CORN LIGHT V4 INSTALLATION



Warning: Added weight of the device may cause instability of a free-standing portable luminaire. Use only with a portable luminaire that is provided with a shade. This lamp uses light emitting diode technology and unlike tungsten-halogen lamps does not require a barrier. Lamp is suitable for open luminaires. Not for emergency lighting.

Warning - Risk of fire or electric shock. LED retrofit kit installation requires knowledge of luminaires, electrical systems. If not qualified, do not attempt installation. Contact a qualified electrician. Install this kit only in the luminaires that have the construction features and dimensions shown in the photographs and/or drawings and where the input rating of the retrofit kit does not exceed the input rating of the luminaire. Warning - to prevent wiring damage or abrasion, do not expose wiring to edges of sheet metal or other sharp objects.

Warning - Risk of fire or electric shock. Luminaire wiring and electrical parts may be damaged when drilling for installation of LED retrofit kit. Check for enclosed wiring and components.

Do not make or alter any open holes in an enclosure of wiring or electrical components during kit installation. This retrofit kit is accepted as a component of a luminaire where the suitability of the combination shall be determined by authorities having jurisdiction. This device is not intended for use with emergency exits and is not intended for emergency lighting.

Avertissement: Le poids supplémentaire de l'appareil peut provoquer l'instabilité d'un luminaire portable autoportant. Utiliser uniquement avec une lampe de table dotée d'un abat-jour. Ne convient pas aux sorties de secours.

Avertissement - précautionnez-vous contre des chocs électriques. L'installation des pièces de rechange LED est seulement en charge des professionnels.

Precautionnez-vous contre feu. Installer des pièces de rechange selon les spécifications, veiller à ce que la puissance d'entrée ne dépasse pas la puissance d'entrée de remplacement de la lampe. Ne faites pas de contact avec le câble pointus ou métalliques, afin d'éviter le fil use. Vérifier le circuit fermé, afin de dom mages les câbles et les composants électroniques lors de l'installation de forage. Ne pas modifier la structure du circuit fermé et les composants électroniques ou forage sur celui-ci lors de l'installation des pièces de rechange.

Do not use an electric generator to test the LED lamp. Please avoid using the LED fixture in an environment where there is smoke, sulfur, and corrosive substances. But if used in such environment, make sure the LED fixture is well protected by an enclosed lamp shade whose dimensions is no less than below size, and whose material is either glass or semi-glass, semi-metallic. Surface of the lampshade shall not have any covering which prevents heat dissipation.

FEATURES

- 360 degree lighting
- Can be used with clear PC cover
- No fan
- 15-125W lamp can be used with AC100-277V internal driver
- 15-125W Sealant pouring for whole driver and lamp plastic housing
- Long lifespan and good heat dissipation
- Direct replacement for Metal Halide, easy installation
- Fits many different fixtures to replace traditional lamps

APPLICATIONS

Mainly used in supermarkets, warehouses, garages, homes, offices, hotels, hospitals, schools, streets, gardens, etc.

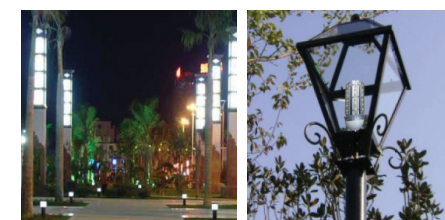

POWER (W)1	15w	19w	27w	36w
MINIMUM ENCLOSURE SIZE (IN)	12.2*7.5*7.5	12.6*7.5*7.5	13.4*7.9*7.9	15*7.9*7.9
VOLUME (CM)	31*19*19	32*19*19	34*20*20	38*20*20

POWER (W)5	54w	80w	100w	125w
MINIMUM ENCLOSURE SIZE (IN)	16.5*7.5*7.5	16.5*9.1*9.1	17.3*9.4*9.4	17.3*10.2*10.2
VOLUME (CM)	42*19*19	42*23*23	4*24*24	4*26*26

Installation in an enclosure smaller than the one specified will void the warranty.

LED CORN LIGHT V4 INSTALLATION

1. Turn off the power switch.
2. Screw off the CFL or MHL or HPS and so on, see Figure (4) (5).
3. Take out LED corn light and screw on, see Figure (1) (2).

Figure (1) (2) (3): AC internal driver,

[Note: Please make sure to take off the ballast before installing LED corn light, otherwise the ballast will produce the resonance of high voltage and makes LED corn light break down.]

4. If security rope is provided, please fix the rope on the lamp with hand, then fix the wire of other and on the shall, see Figure (3).
5. Turn on the power switch. [Finished!]

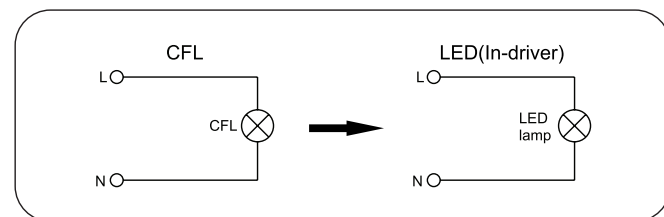
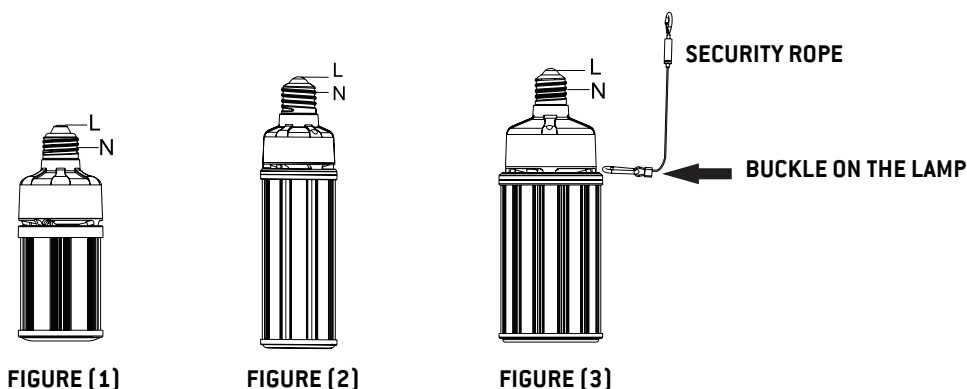

FIGURE (4)

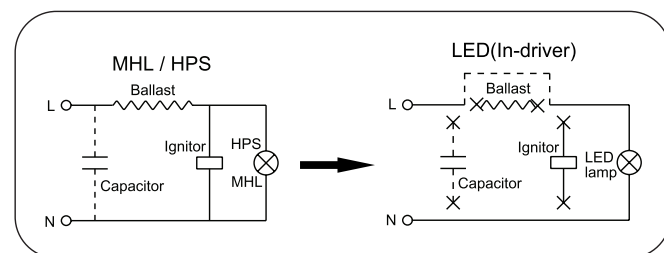

FIGURE (5)

LED C/W SELECTABLE CORN LIGHT INSTALLATION



Warning: Added weight of the device may cause instability of a free-standing portable luminaire. Use only with a portable luminaire that is provided with a shade. This lamp uses light emitting diode technology and unlike tungsten-halogen lamps does not require a barrier. Lamp is suitable for open luminaires. Not for emergency lighting.

Warning - Risk of fire or electric shock. LED retrofit kit installation requires knowledge of luminaires, electrical systems. If not qualified, do not attempt installation. Contact a qualified electrician. Install this kit only in the luminaires that have the construction features and dimensions shown in the photographs and/or drawings and where the input rating of the retrofit kit does not exceed the input rating of the luminaire. **Warning -** to prevent wiring damage or abrasion, do not expose wiring to edges of sheet metal or other sharp objects.

Warning - Risk of fire or electric shock. Luminaire wiring and electrical parts may be damaged when drilling for installation of LED retrofit kit. Check for enclosed wiring and components.

Do not make or alter any open holes in an enclosure of wiring or electrical components during kit installation. This retrofit kit is accepted as a component of a luminaire where the suitability of the combination shall be determined by authorities having jurisdiction. This device is not intended for use with emergency exits and is not intended for emergency lighting.

Avertissement: Le poids supplémentaire de l'appareil peut provoquer l'instabilité d'un luminaire portable autoportant. Utiliser uniquement avec une lampe de table dotée d'un abat-jour. Ne convient pas aux sorties de secours.

Avertissement - précautionnez-vous contre des chocs électriques. L'installation des pièces de rechange LED est seulement en charge des professionnels.

Precautionnez-vous contre feu. Installer des pièces de rechange selon les spécifications, veiller à ce que la puissance d'entrée ne dépasse pas la puissance d'entrée de remplacement de la lampe. Ne faites pas de contact avec le câble pointus ou métalliques, afin d'éviter le fil use. Vérifier le circuit fermé, afin de dom mages les câbles et les composants électroniques lors de l'installation de forage. Ne pas modifier la structure du circuit fermé et les composants électroniques ou forage sur celui-ci lors de l'installation des pièces de rechange.

Do not use an electric generator to test the LED lamp. Please avoid using the LED fixture in an environment where there is smoke, sulfur, and corrosive substances. But if used in such environment, make sure the LED fixture is well protected by an enclosed lamp shade whose dimensions is no less than below size, and whose material is either glass or semi-glass, semi-metallic. Surface of the lampshade shall not have any covering which prevents heat dissipation.

FEATURES

- 27-100W are CCT selectable and wattage selectable (100W has PIR and Microwave sensor options)
- No internal fan
- 27-100W lamp can be used with AC100-277V internal driver
- Internally potted driver.
- Long-lifespan and good heat dissipation
- Fits many different fixtures to replace traditional lamps

APPLICATIONS

Mainly used in supermarkets, warehouses, garages, homes, offices, hotels, hospitals, schools, streets, gardens, etc.



Power (W)	27	45	63	100
Volume (IN)	13.8*7.8*7.8	16.5*8.3*8.3	16.5*9*9	17.3*9.4*9.4

Installation in an enclosure smaller than the one specified will void the warranty.

LED CORN LIGHT INSTALLATION INSTRUCTIONS

1. Turn off the luminaire power supply.
2. Ensure that there is no power going to the luminaire by checking the voltage at the input leads of the luminaire (Line and Neutral) using a volt-meter.
3. Remove old lamp from luminaire.
4. This lamp cannot operate on an HID Ballast. Open luminaire housing and verify that the internal ballast has been disconnected and/or removed from the luminaire circuit. If ballast is still wired to luminaire lamp holder, remove the ballast from the circuit. Connect the lamp holder line and neutral wires directly to the luminaire power supply to bypass the internal ballast. Lamps are designed to operate at 100-277V AC line voltage. See Figures A and B below.

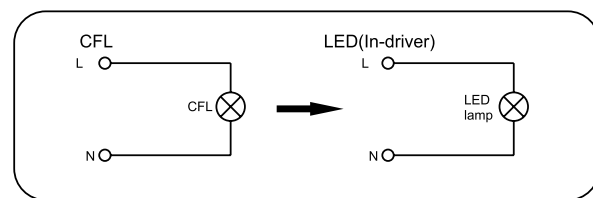

FIGURE A

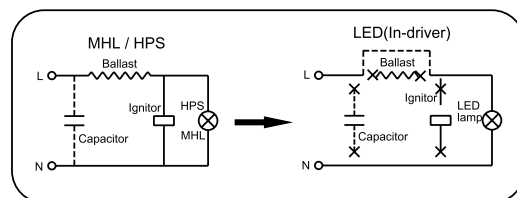
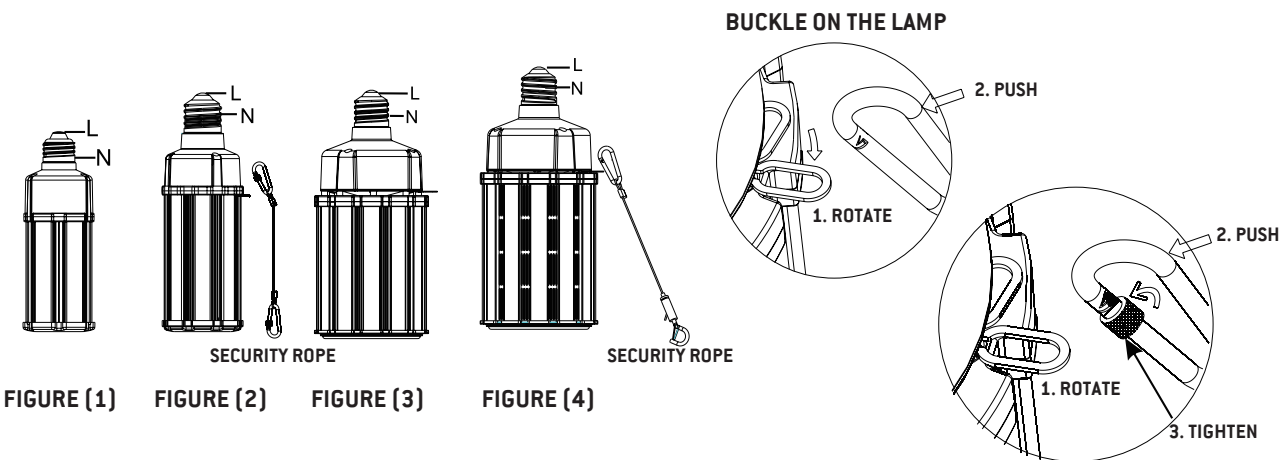

FIGURE B

5. Once ballast is removed from circuit, reassemble luminaire and screw LED lamp into lamp socket.
6. Install lamp security rope to the lamp and connect it to the luminaire to prevent the lamp from falling in case of socket failure. [See Figures 1-4]



7. CCT and Wattage may be changed by removing the coin plug at the top of the lamp (end opposite of the base) and adjusting the dial using a screw driver. [See Figure 5 below]

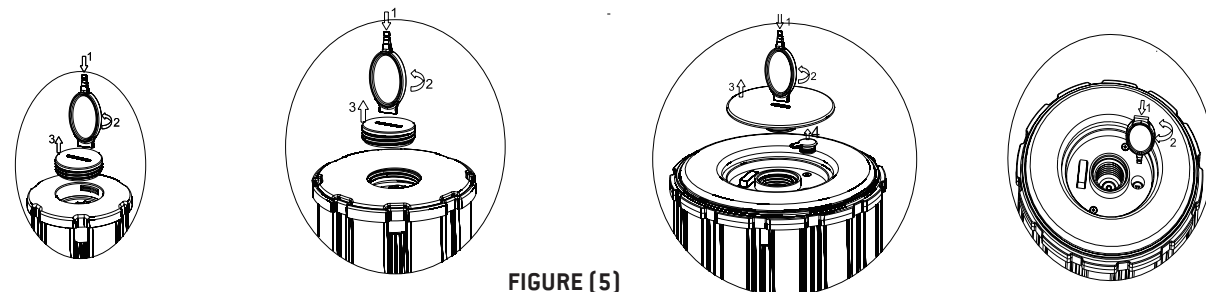
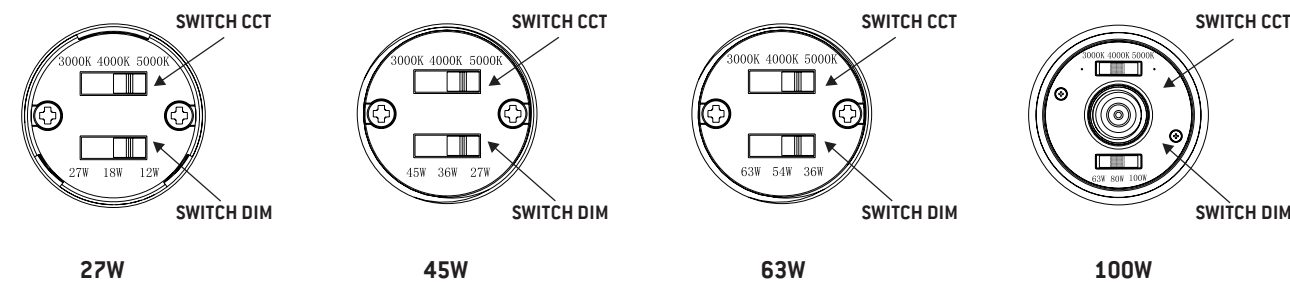

FIGURE (5)

LED CORN LIGHT INSTALLATION INSTRUCTIONS

CCT SELECTABLE AND WATTAGE SELECTABLE DIMMING MODE DIAGRAM



Rated Wattage	Dimming Mode
27W	12W 18W 27W
45W	27W 36W 45W
63W	36W 54W 63W
100W	63W 80W 100W

INSTALLATION OF MOTION OR PIR SENSOR

It could be easily installed by using a straight screwdriver. Use a flat-blade screwdriver to unscrew the plug and remove the plug. Adjust the lamp power to maximum (otherwise, the sensor, will act abnormally). Install the motion or PIR sensor and tighten it.

Note: the motion sensor has no dialing code, and a remote control is needed for adjustment. Please refer to the instruction for remote control adjustment.

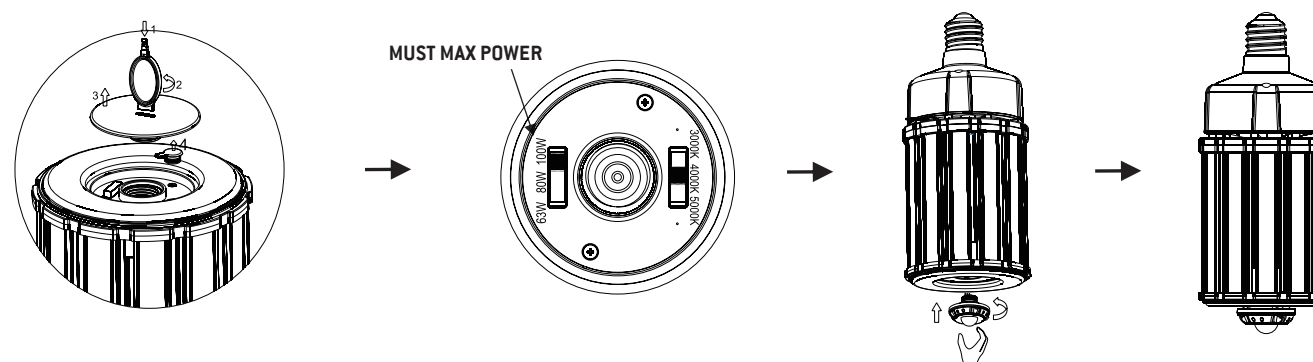

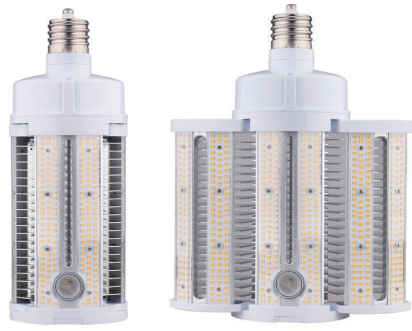

FEATURES

- Two dimming modes optional, continuous dimming or sensor dimming.
- Can be with clear or frosted PC cover.
- Pure aluminum heatsink, no fans.
- 75-100W lamp can be with AC120-277V internal driver.
- 75-110W Driver is potted and protected with a plastic housing.
- Long lifespan and good heat dissipation.
- Ballast bypass direct replacement for Metal Halide, easy installation. (ballast must be completely bypassed).
- Fits many different fixtures to replace traditional lamps.
- Operating ambient temperature can be up to 122°F.
- Microwave or PIR sensors available.
- Lighting angle optional.
- Lamp base can be rotatable to make sure the luminous direction of LED area lamp is consistent with the outside fixture.

APPLICATION:

LED Retrofit Kit make it simple to replace: parking lot lighting, shoebox lighting, street lighting, flood lighting, wall pack lighting, canopy lighting

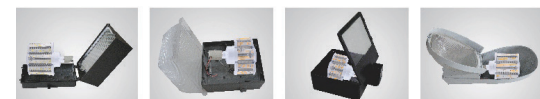
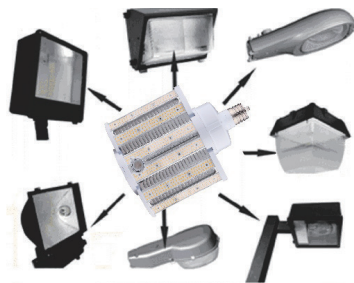

LED AREA LIGHT INSTALLATION

Warning: Added weight of the device may cause instability of a free-standing portable luminaire. Use only with a portable luminaire that is provided with a shade. This lamp uses light emitting diode technology and unlike tungsten- halogen lamps does not require a barrier. Lamp is suitable for open luminaires. Not for emergency lighting.

Warning - Risk of fire or electric shock. LED retrofit kit installation requires knowledge of luminaires, electrical systems. If not qualified, do not attempt installation. Contact a qualified electrician. Install this kit only in the luminaires that have the construction features and dimensions shown in the photographs and/or drawings and where the input rating of the retrofit kit does not exceed the input rating of the luminaire. Warning - to prevent wiring damage or abrasion, do not expose wiring to edges of sheet metal or other sharp objects.

Warning - Risk of fire or electric shock. Luminaire wiring and electrical parts may be damaged when drilling for installation of LED retrofit kit. Check for enclosed wiring and components.

Do not make or alter any open holes in an enclosure of wiring or electrical components during kit installation. This retrofit kit is accepted as a component of a luminaire where the suitability of the combination shall be determined by authorities having jurisdiction. This device is not intended for use with emergency exits and is not intended for emergency lighting.

Avertissement: Le poids supplémentaire de l'appareil peut provoquer l'instabilité d'un luminaire portable autoportant. Utiliser uniquement avec une lampe de table dotée d'un abat-jour. Ne convient pas aux sorties de secours.

Avertissement - prenez garde contre des chocs électriques. L'installation des pièces de rechange LED est seulement en charge des professionnels.

Precautionnez-vous contre feu. Installer des pièces de rechange selon les spécifications, veiller à ce que la puissance d'entrée ne dépasse pas la puissance d'entrée de remplacement de la lampe. Ne faites pas de contact avec le câble pointus ou métalliques, afin d'éviter le fil use. Vérifier le circuit fermé, afin de domager les câbles et les composants électroniques lors de l'installation de forage. Ne pas modifier la structure du circuit fermé et les composants électroniques ou forage sur celui-ci lors de l'installation des pièces de rechange.

Do not use an electric generator to test the LED lamp. Please avoid using the LED fixture in an environment where there is smoke, sulfur, and corrosive substances. But if used in such environment, make sure the LED fixture is well protected by an enclosed lamp shade whose dimensions is no less than below size, and whose material is either glass or semi-glass, semi-metallic. Surface of the lampshade shall not have any covering which prevents heat dissipation.

Power (W)	75	95	110
Minimum Enclosure Size (IN)	16.54*9.05*9.05*	17.32*9.44*9.44	17.32*10.23*10.23
Volume (CM)	42*23*23	44*24*24	44*26*26

Installation in an enclosure smaller than the one specified will void the warranty

LED AREA LIGHTING INSTALLATION INSTRUCTIONS

1. Turn off the power switch.
2. Screw off the CFL or MHL or HPS, see figure (1) (2).
3. Take out the LED area lamp and screw it on. After the LED are a lamp is well tightened adjust it slightly to make sure that the direction of sensor hole of the LED are a lamp is the same as the light emitting surface of the outside fixture, see Figure (3). Then insert your hands into the slots on both sides and open the radiator, see Figure (4).
4. Adjust the lighting angle of the LED area lamp as required, with 0 degree, 25 degree, 50 degree, and 75 degree optional, see Figure (5).
5. Figure (6): Regular lamp, lamp with motion sensor or PIR sensor. LED lamp, equipped with motion sensor or PIR sensor, is not compatible with continuous dimming. See the Figure (8) for sensor installation instructions.
(Note: Make sure to take off the ballast before installing LED area lamp, otherwise the ballast will produce the resonance of high voltage and that will cause damage to the lamps internal circuitry.)
6. Security rope provided, fix the rope on the lamp with hand, then fix the wire of other end on the luminaire housing see Figure (7).
7. Turn on the power switch. (Finished!)

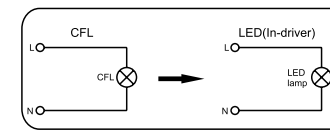

FIGURE (1)

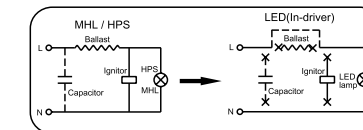

FIGURE (2)

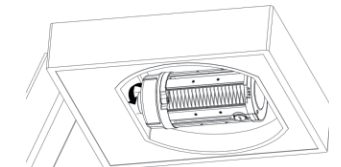
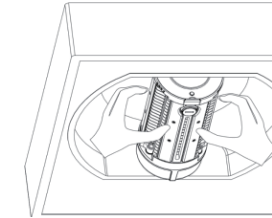
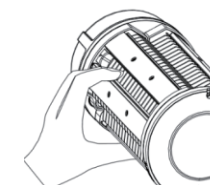

FIGURE (3)



INSERT YOUR HANDS INTO SLOTS TO OPEN THE RADIATOR

FIGURE (4)

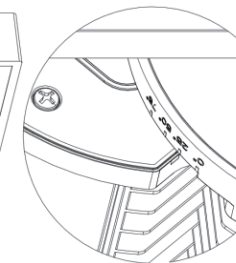
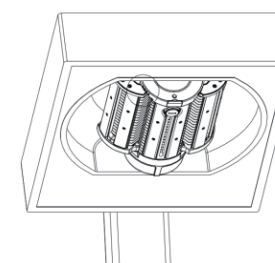

FIGURE (5)

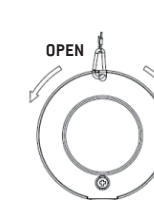

FIGURE (6)

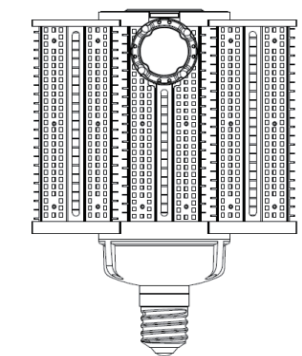
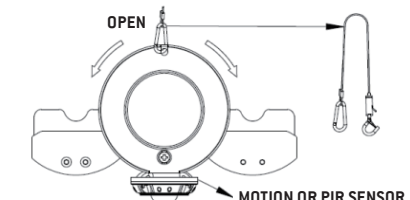

FIGURE (7)

INSTALLATION OF MOTION SENSOR OR PIR SENSOR

It could be easily installed by using a flat-blade screwdriver. Use a flat-blade screwdriver to unscrew the plug and remove the plug. Then choose motion sensor or PIR sensor to install and tighten.

Note: The motion sensor has no dialing code, and a remote control is needed for adjustment. Please refer to the instruction for remote control adjustment.

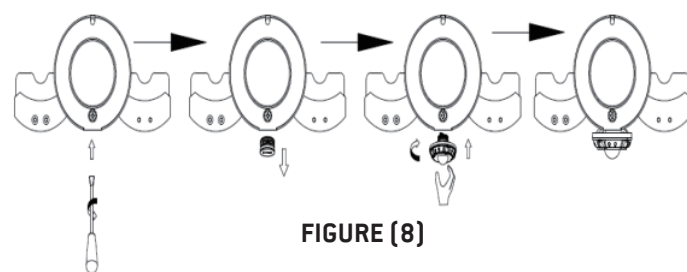

FIGURE (8)

LED AREA LIGHTING INSTALLATION INSTRUCTIONS

WARNING

THIS DEVICE IS NOT INTENDED FOR USE WITH EMERGENCY EXITS ADDED WEIGHT OF THE DEVICE MAY CAUSE INSTABILITY OF A FREE-STANDING PORTABLE LUMINAIRE USE ONLY WITH A PORTABLE TABLE LUMINAIRE THAT IS PROVIDED WITH A SHADE

AVERTISSEMENT

NE CONVIENT PAS AUX SORTIES DE SECOURS LE DISPOSITIF CONSTITUE UN POIDS SUPPLEMENTAIRE CE QUI PEUT CAUSER L'INSTABILITE D'UN LUMINAIRE PORTATIF AUTONOME UTILISER UNIQUEMENT AVEC UNE LAMPE DE TABLE DOTEE D'UN ABAT-JOUR

FCC STATEMENT

This device complies with Part 15 of the FCC Rules. Operation is subject to the following two conditions:

- (1) This device may not cause harmful interference .
 - (2) This device must accept any interference received, including interference that may cause undesired operation.
2. Changes or modifications not expressly approved by the party responsible for compliance could void the user's authority to operate the equipment.

Note: This equipment has been tested and found to comply with the limits for a class B digital device, pursuant to Part 15 of the FCC Rules. These limits are designed to provide reasonable protection against harmful interference in a residential installation .

This equipment generates uses and can radiate radio frequency energy and ,if not installed and used in accordance with the instructions, may cause harmful interference to radio communications. However there is no guarantee that interference will not occur in a particular installation .if this equipment does cause harmful interference to radio or television reception, which can be determined by turning the equipment off and on, the user is encouraged to try to correct the interference by one or more of the following measures:

- Reorient or relocate the receiving antenna.
- Increase the separation between the equipment and receiver.
- Connect the equipment into an outlet on a circuit different from that to which the receiver is connected .
- Consult the dealer or an experienced radio/TV technician for help.

IC STATEMENT

This device contains license-exempt transmitter(s)/receiver(s) that comply with Innovation, Science and Economic Development Canada's license-exempt RSS(s). Operation is subject to the following two conditions:

1. This device may not cause interference.
2. This device must accept any interference, including interference that may cause undesired operation of the device.

This equipment should be installed and operated with a minimum distance of 20 cm between the radiator and your body.

Le present appareil est conforme aux CNR d'Industrie Canada applicables aux appareils radio exempts de licence.

L'exploitation est autorisee aux deux conditions suivantes: (1) l'appareil ne doit pas produire de brouillage, et (2) l'utilisateur de l'appareil doit accepter tout brouillage radioelectrique subi, meme si le brouillage est susceptible d'en compromettre le fonctionnement.

CAN ICES-5 (B)/NMB-5 (B)

Cet equipement doit etre installe et utilise a une distance minimale de 20 cm entre le radiateur et votre corps.

HBR INSTALLATION INSTRUCTIONS

Warning: Please make sure the power is off before installation.

1. Turn off power switch.
2. Remove the CFL, MHL, HPS, or L.E.D. lamp from luminaire.
3. Wire luminaire so that it by-passes any previously installed drivers/ballasts. See Figures 4 and 5.
4. Remove L.E.D. Retrofit lamp and install in luminaire. See Figure (1).

[Note: Please ensure that any ballasts or drivers are removed prior to installing this L.E.D. retrofit. (See Figure 5). If it is not removed the ballast will produce the resonance of high voltage and makes L.E.D. Retrofit breakdown.]

5. The lamp base can be extended to allow for installations in narrow luminaires. There are two extension settings (See Figure 2).
6. If provided, install security rope. Attach the lamp to the luminaire using the security rope carabiners (See Figure 3).
7. Turn on power switch (Finished!).

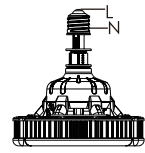
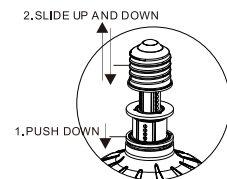
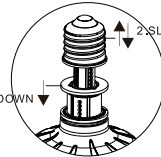

FIGURE (1)



1. PUSH DOWN

2. SLIDE UP AND DOWN



1. PUSH DOWN

2. SLIDE UP AND DOWN

FIGURE (2)

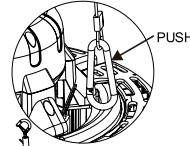

FIGURE (3)

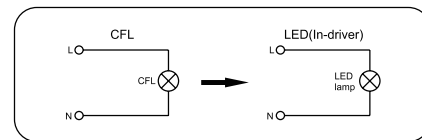

FIGURE (4)

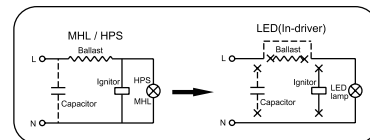

FIGURE (5)

WARNING: NOT FOR USE IN ENCLOSED FIXTURES. NOT FOR EMERGENCY LIGHTING.

WARNING – RISK OF FIRE OR ELECTRIC SHOCK. LED RETROFIT KIT INSTALLATION REQUIRES KNOWLEDGE OF LUMINAIRE ELECTRICAL SYSTEMS. IF NOT QUALIFIED, DO NOT ATTEMPT INSTALLATION. CONTACT A QUALIFIED ELECTRICIAN. INSTALL THIS KIT ONLY IN THE LUMINAIRE THAT HAVE THE INPUT RATING OF THE RETROFIT KIT DOES NOT EXCEED THE INPUT RATING OF THE LUMINAIRE. WARNING – TO PREVENT WIRING DAMAGE OR ABRASION, DO NOT EXPOSE WIRING TO EDGES OF SHEET METAL OR OTHER SHARP OBJECTS. DO NOT MAKE OR ALTER ANY OPEN HOLES IN AN ENCLOSURE OF WIRING OR ELECTRICAL COMPONENTS DURING KIT INSTALLATION. THIS DEVICE IS NOT INTENDED FOR USE WITH EMERGENCY EXITS OR NOT FOR EMERGENCY LIGHTING.

AVERTISSEMENT:

NE CONVIENT PAS AUX SORTIES DE SECOURS. AVERTISSEMENT - PRECAUTIONNEZ-VOUS CONTRE DES CHOCS ÉLECTRIQUES. L'INSTALLATION DES PIÈCES DE RECHANGE LED EST SEULEMENT EN CHARGE DES PROFESSIONNELS. PRECAUTIONNEZ-VOUS CONTRE FEU. INSTALLER DES PIÈCES DE RECHANGE SELON LES SPÉCIFICATIONS, VEILLER À CE QUE LA PUISSANCE D'ENTRÉE NE DÉPASSE PAS LA PUISSANCE D'ENTRÉE DE REMPLACEMENT DE LA LAMPE. NE FAITES PAS DE CONTACT AVEC LE CÂBLE POINTUS OU MÉTALLIQUES, AFIN D'ÉVITER LE FIL USÉ. VÉRIFIER LE CIRCUIT FERMÉ, AFIN DE DOMMAGES LES CÂBLES ET LES COMPOSANTS ÉLECTRONIQUES LORS DE L'INSTALLATION DE FORAGE. NE PAS MODIFIER LA STRUCTURE DU CIRCUIT FERMÉ ET LES COMPOSANTS ÉLECTRONIQUES OU FORAGE SUR CELUI-CI LORS DE L'INSTALLATION DES PIÈCES DE RECHANGE.

SINGLE ENDED BYPASS/LINE VOLTAGE INSTRUCTIONS

FLED15T8/8XX/BYPASS FLED18T8/8XX/BYPASS

Product Features

UL Certified
Full glass housing: No aging, yellowing, bending

1. Product Features:

UL Certified
Full glass housing: No Aging, Yellowing, Bending.
Double ended

2. Product Applications:

Widely used in residential buildings, offices, shopping malls, supermarkets, hospitals, assembly lines, warehouses, etc. for energy saving illumination.

3. Installation Instructions:

Please completely comply with these instructions and notes, to ensure that the product is operated in a safe condition.

Safety Precautions:

For your and others' safety, please read the precaution carefully before installation:

- (1). Product should be installed by qualified electrician.
- (2). Switch off the power supply before commencing work, make sure correct connection before power on.
- (3). Do not apply uncertified LED driver with the product.

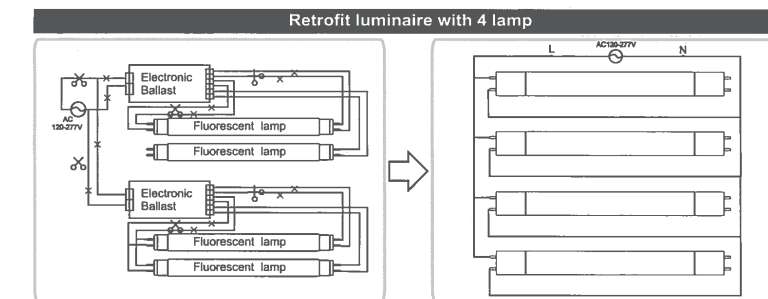
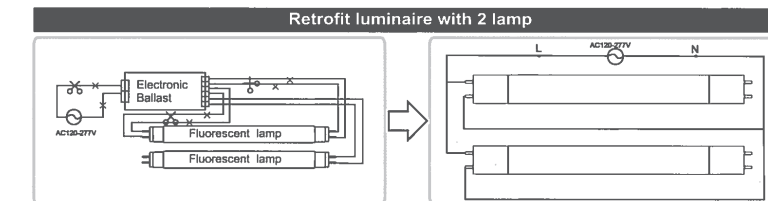
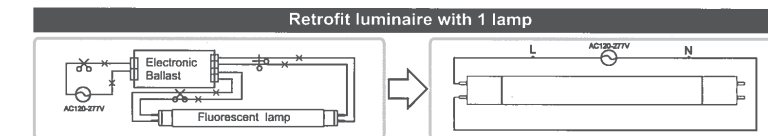

Wiring Instruction - Magnetic Ballast



SINGLE ENDED BYPASS/LINE VOLTAGE INSTRUCTIONS

Installers should not disconnect existing wires from lampholder terminals to make new connections at lampholder terminals. Instead installers should cut existing lampholder leads away from the lampholder and make new electrical connections to lampholder lead wires by employing applicable connectors.

Les installateurs ne doivent pas debrancher les cables existants de terminaux de support de lampe pour faire de nouvelles connexions dans les douilles. Au lieu installateurs doivent couper les cables existants de terminaux de support de lampe et faire de nouvelles connexions electriques en utilisant des connecteurs applicables.

WARNING - RISK OF FIRE OR ELECTRIC SHOCK. DO NOT ALTER, RELOCATE, OR REMOVE WIRING, LAMP HOLDERS, POWER SUPPLY, OR ANY OTHER ELECTRICAL COMPONENT.

AVERTISSEMENT - RISQUES D'INCENDIE OU DE CHOC ELECTRIQUE. NE PAS MODIFIER, REPLACER OU DEBRANCHER LES CABLES, LES DOUILLES D'ALIMENTATION, OUTOUTEAUTRE COMPOSANT ELECTRIQUE.

THE RETROFIT ASSEMBLY IS ACCEPTED AS A COMPONENT OF A LUMINAIRE WHERE THE SUITABILITY OF THE COMBINATION SHALL BE DETERMINED BY UL OR AUTHORITIES HAVING JURISDICTION.

LE MONTAGE DU RETROFIT EST ACCEPTEE COMME COMPOSANT D'UN LUMINAIRE OU LA PERTINENCE DE LA COMBINAISON SERA DETERMINEE PAR L'UL OU LES AUTORITES AYANT LA JURIDICTION CORRESPONDANTE.

This device complies with Part 15 of the FCC Rules. Operation is subject to the following two conditions: (1) this device may not cause harmful interference, and (2) this device must accept any interference received, including interference that may cause undesired operation.

WARNING:

Risk of fire or electric shock. Installation of this Retrofit Kit requires knowledge of electrical systems. If you are not qualified, do not attempt installation, and contact a qualified electrician.

Risque d'incendie ou de choc electrique. L'installation de ce kit Retrofit necessite des connaissances specifiques des systemes electriques. Si vous n'etes pas qualifie, n'essayez pas de l'installer, et prenez contact avec un electricien qualifie.

Install this kit only in luminaries that have the construction features and dimensions shown in the photographs and drawings.

Installez ce kit dans les luminaires qui disposent des caracteristiques de conception et des dimensions indiquees sur les photographies et sur les schemas.

Do not make or alter any open holes in an enclosure of wiring or electrical components during kit installation.

Ne pas agrandir ou modifier les trous ouverts au sein du cablage ou sur les composants electriques lors de l'installation du kit.

To prevent damage to wiring, do not expose wires to the edges of sheet metal or other sharp objects.

Pour eviter d'endommager le cablage, ne pas exposer les fils sur les bords de tole metalliques ou sur d'autres objets pointus.

WARNING: To avoid potential fire or shock hazard, do not use this retrofit kit in luminaires employing shunted bi-pin lampholders. Note: Shunted lamp holders are found only in fluorescent luminaires with Instant-Start ballasts. Instant-start ballasts can be identified by the words "Instant Start" or "I.S." marked on the ballast. This designation may be in the form of a statement pertaining to the ballast itself, or may be combined with the marking for the lamps with which the ballast is intended to be used, for example F40T12/IS. For more information, contact the LED luminaire retrofit kit manufacturer. AVERTISSEMENT: Pour eviter tout incendie potentiel ou tout risque de choc, ne pas utiliser ce kit de renovation dans les luminaires utilisant des douilles shuntees a deux broches. Remarque: les supports de lampe shunte ne se trouvent que sur les luminaires fluorescents avec ballasts et a allumage instantane. Les ballastes a allumage instantane peuvent etre identifiees par les mots "Demarrage instantane" ou "I.S." sur la ballaste. Cette designation peut etre presentee sous la forme d'une declaration relatives au ballast lui-meme, ou peut etre combinee avec le marquage pour les lampes dont le ballast est destine a etre utilise, par exemple le modele F40T12 / EST. Pour plus d'informations, contactez le fabricant du kit de renovation de luminaire LED.

DOUBLE ENDED BYPASS/LINE VOLTAGE INSTRUCTIONS

Operation Instruction

Double ended Bypass/Line Voltage

Product Name: LED TB Tube Series

Product Model: TB-LED

1. Product Features:

UL Certified

Full glass housing: No Aging, Yellowing, Bending.

Double ended

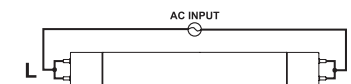

2. Product Applications:

Widely used in residential buildings, offices, shopping malls, supermarkets, hospitals, assembly lines, warehouses, etc. for energy saving illumination.

3. Installation Instructions:

Please completely comply with these instructions and notes, to ensure that the product is operated in a safe condition.

Safety Precautions:

For your and others' safety, please read the precaution carefully before installation:

- {1}. Product should be installed by qualified electrician.
- {2}. Switch off the power supply before commencing work, make sure correct connection before power on.
- {3}. Only use the control provided with or specified by these instructions to control this lamp. This lamp will not operate properly when connected to a standard (incandescent) dimmer or dimming control.

The units covered by this report were intended to retrofit surface mount, Type IC or non-IC recessed mount Listed fluorescent luminaires that use maximum 4 tubular lamps, the minimum lamp compartment dimensions are tabulated below:

MODEL NUMBER	MINIMUM LAMP COMPARTMENT DIMENSION [LENGTH x WIDTH X HEIGHT] [mm]	LAMP QTY	LAMP-to-lamp Spacing [cm]
FDT14T8/8XX/DEBYPASS	48.43"x 13.39"x 1.78"	4	3
FDT17T8/8XX/DEBYPASS	48.43"x 13.39"x 1.78"	4	3
CFLED14T8/8XX/DEBYPASS	48.43"x 13.39"x 1.78"	4	3

This device complies with Part 15 of the FCC Rules. Operation is subject to the following two conditions: {1} this device may not cause harmful interference, and {2} this device must accept any interference received, including interference that may cause undesired operation.

DOUBLE ENDED BY PASS/LINE VOLTAGE INSTRUCTIONS

The below ballast wiring represents typical configuration.

The actual ballast wiring varies according to ballast model. It is not needed to change socket (if in good condition) to operate double ended lamps, regardless the type of sockets. Please make sure one side of fixture is connected to Live (L) and the other side to Neutral (N).

Wiring Instruction

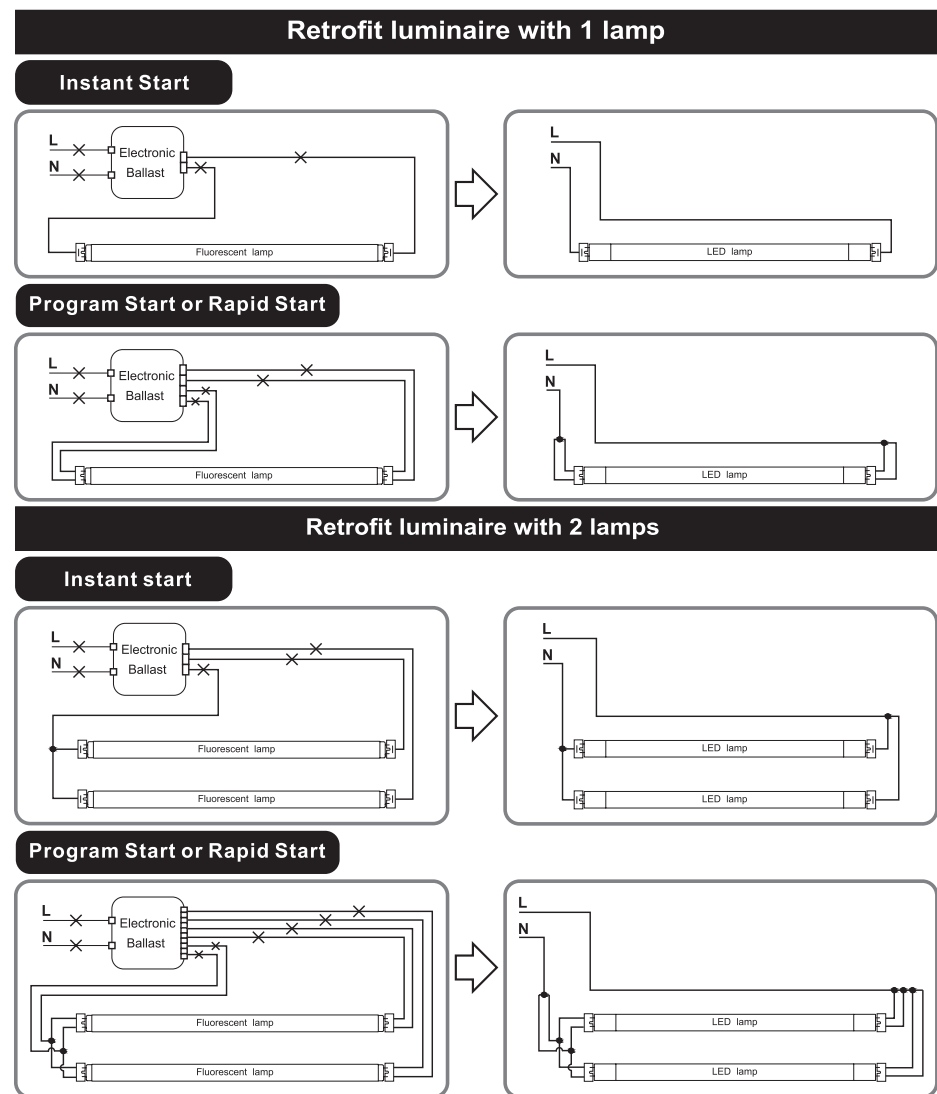

DOUBLE ENDED BY PASS/LINE VOLTAGE INSTRUCTIONS

The below ballast wiring represents typical configuration.

The actual ballast wiring varies according to ballast model. It is not needed to change socket (if in good condition) to operate double ended lamps, regardless the type of sockets. Please make sure one side of fixture is connected to Live (L) and the other side to Neutral (N).

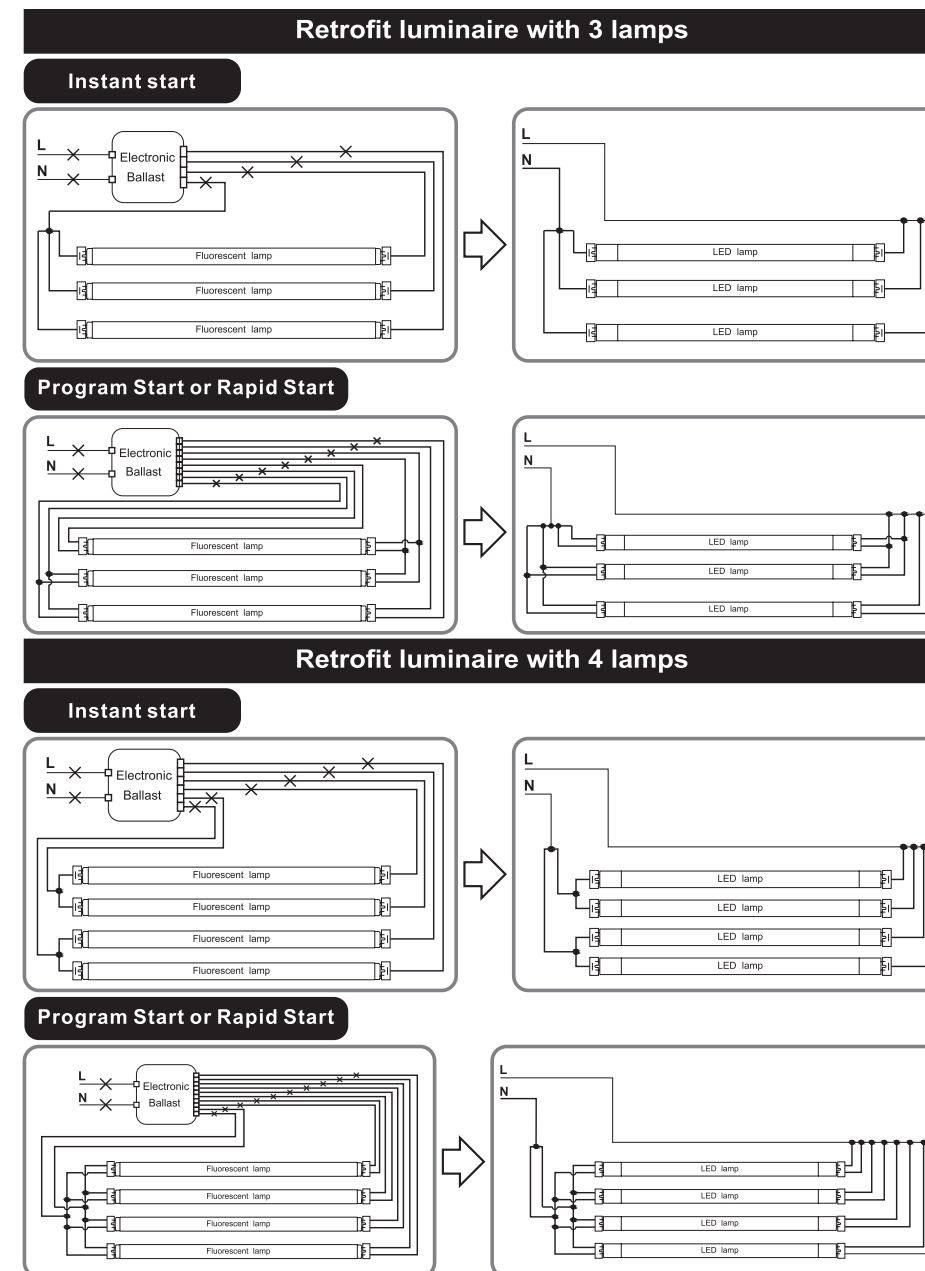

DOUBLE ENDED BY PASS/LINE VOLTAGE INSTRUCTIONS

WARNING - Risk of fire or electric shock. LED Retrofit Kit installation requires knowledge of luminaires electrical systems. If not qualified, do not attempt installation. Contact a qualified electrician.

AVERTISSEMENT - Risque d'incendie ou de choc électrique. Installation du kit de Retrofit LED exige une connaissance des systèmes électriques luminaires. Si vous n'êtes pas qualifié, ne tentez pas de l'installation. Contactez un électricien qualifié.

WARNING - Risk of fire or electric shock. Install this kit only in the luminaires that have the construction features and dimensions shown in the photographs and/or drawings and where the input rating of the retrofit kit does not exceed the input rating of the luminaire.

AVERTISSEMENT - Risque d'incendie ou de choc électrique. Installez ce kit dans les luminaires qui ont les caractéristiques de construction et les dimensions indiquées dans les photographies et / ou dessins et où la cote d'entrée du kit de modification ne dépasse pas la capacité d'entrée du luminaire.

Do not make or alter any open holes in an enclosure of wiring or electrical components during kit installation.

Ne pas agrandir ou modifier les trous ouverts au sein du câblage ou sur les composants électriques lors de l'installation du kit.

WARNING - To prevent wiring damage or abrasion, do not expose wiring to edges of sheet metal or other sharp objects.

AVERTISSEMENT - Pour éviter d'endommager le câblage ou à l'abrasion, ne pas exposer le câblage aux bords de tôle ou d'autres objets pointus.

Installers should not disconnect existing wires from lamp holder terminals

to make new connections at lamp holder terminals. Instead installers

should cut existing lamp holder leads away from the lamp holder and make new electrical connections to lamp holder lead wires by employing

applicable connectors.

Les installateurs ne doivent pas débrancher les câbles existants de

terminaux de support de lampe pour faire de nouvelles connexions dans

les douilles. Au lieu installateurs doivent couper les câbles existants de terminaux de support de lampe et faire de nouvelles connexions électriques

en utilisant des connecteurs applicables.

THIS RETROFIT ASSEMBLY IS ACCEPTED AS A COMPONENT OF A LUMINAIRE WHERE THE SUITABILITY OF THE COMBINATION SHALL BE DETERMINED BY UL OR AUTHORITIES HAVING JURISDICTION.

LE MONTAGE DU RETROFIT EST ACCEPTÉE COMME COMPOSANT D'UN LUMINAIRE OÙ LA PERTINENCE DE LA COMBINAISON SERA DÉTERMINÉE PAR L'UL OU LES AUTORITÉS AVANT LA JURIDICTION CORRESPONDANTE. THERE ARE LED TUBE, OPERATION INSTRUCTION AND FIELD APPLIED LABEL IN THIS RETROFIT KIT.

Type B LAMP - intended for operation in luminaires with traditional fluorescent-type lamp holders wired directly to the branch circuit. This includes both factory-wired luminaires as well as those converted for this purpose under a retrofit program.

INSTALLATION GUIDE TYPE A+B LED T8 TUBE LIGHT

Please keep this Quick Installation Guide for future reference. Modifications to the product void the Warranty. Suitable to replace fluorescent lamps as specified on the product label.

MARKINGS/WARNINGS:

A. RISK OF FIRE OR ELECTRIC SHOCK. When working with electronic ballasts please check the compatibility list first. If the ballast can't be found in the list, please bypass the fixture or contact the manufacturer. Do not install the tube if the ballast is not on the list.

B. CAUTION RISK OF FIRE - If the lamp or luminaire exhibits undesirable operation (buzzing, flickering, etc.), immediately turn off power, remove lamp from luminaire and contact manufacturer.

C. DO NOT INSTALL THIS LAMP IN A PRE-HEAT LUMINAIRE.

D. THIS LAMP ONLY OPERATES ON ELECTRONIC BALLASTS. IF LAMP DOES NOT LIGHT WHEN THE LUMINAIRE IS ENERGIZED, REMOVE LAMP FROM LUMINAIRE AND CONTACT LAMP MANUFACTURER OR QUALIFIED ELECTRICIAN.

E. THIS DEVICE IS NOT INTENDED FOR USE WITH EMERGENCY EXITS. NOT FOR EMERGENCY LIGHTING.

F. WARNING – Risk of fire or electric shock. L.E.D. retrofit kit installation requires knowledge of luminaires electrical systems. If not qualified, do not attempt installation. Contact a qualified electrician.

G. WARNING – Risk of fire or electric shock. Install this kit only in the luminaires that have the construction features and dimensions shown in the photographs and/or drawings and where the input rating of the retrofit kit does not exceed the input rating of the luminaire.

H. Do not make or alter any open holes in an enclosure of wiring or electrical components during kit installation.

I. Warning – to prevent wiring damage or abrasion, do not expose wiring to edges of sheet metal or other sharp objects. Installers should not disconnect existing wires from lampholder terminals to make new connections at lampholder terminals. Instead installers should cut existing lampholder leads away from the lampholder and make new electrical connections to lampholder lead wires by employing applicable connectors.

J. WARNING FOR SINGLE-ENDED POWER INPUT: To avoid potential fire or shock hazard, do not use this retrofit kit in luminaires employing shunted bi-pin lampholders. Note: shunted lamp holders are found only in fluorescent luminaires with instant-start ballasts. Instant-start ballasts can be identified by the words "instant start" or "i.s." marked on the ballast. This designation may be in the form of a statement pertaining to the ballast itself or may be combined with the marking for the lamps with which the ballast is intended to be used, for example F40T12/IS. For more information, contact the L.E.D. luminaire retrofit kit manufacturer.

K. If the tube is installed as type b, once the luminaire is modified as a retrofit fixture, it will no longer operate fluorescent lamps.

Type A – Assembly Wiring Diagram

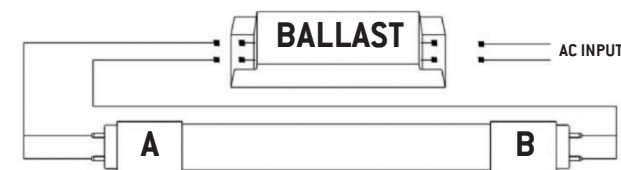

Type A-Installation Guide:

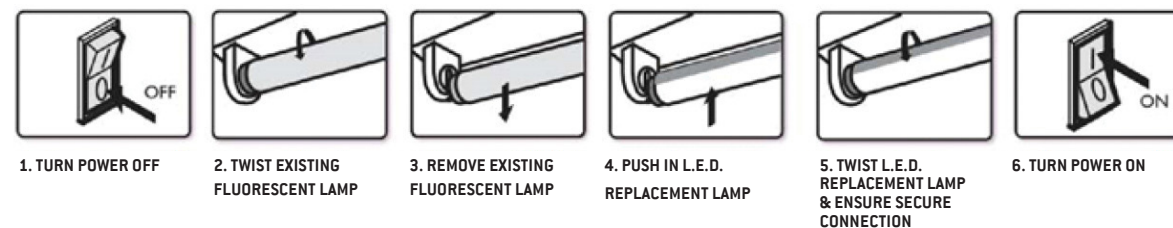

Instructions:

Note: Before installation, please check specifications for the most current ballast compatibility list, if no match, please insert led tubes according to below type B installation instructions.

1. Switch-off power to the luminaire.
2. Remove the diffuser (If provided).
3. Remove the existing fluorescent lamps from the luminaire.
4. Install the L.E.D. tube lamp.
5. Install the diffuser (if removed in step 2).
6. Switch on power to the luminaire.

INSTALLATION GUIDE TYPE A+B LED T8 TUBE LIGHT

TYPE B – INSTALLATION GUIDE:

Instructions:

1. Switch-off Power to the luminaire.

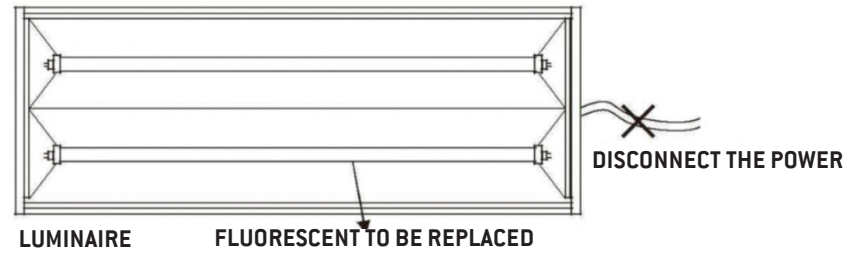

2. Disconnect power to luminaire before installation. Using a voltmeter or other method to confirm that no power is going to the luminaire.

3. Remove luminaire accessories to get to ballast compartment.

- a. Remove troffer lens, if present.
- b. Remove existing tube lamp(s).
- c. Remove luminaire ballast cover (Cover may be secured with screws or tabs).



A. REMOVE TROFFER LENS TO EXPOSE LAMPS AND BALLST COVER

B. REMOVE TUBE LAMPS

C. REMOVE LUMINAIRE BALLAST COVER



QUESTIONS?
If you have any questions please contact us at
info@fusion-lamps.com



FUSION
LAMPS

www.FUSION-LAMPS.com

All our products are available exclusively
at City Electric Supply.

Visit www.cityelectricsupply.com to find a branch near you.

TAMCO

11675 TOM MACKIE BLVD.
PORT ST. LUCIE, FL 34987
P. 772.878.4944

www.TAMCOGROUP.com

Printed in **USA**



1 90010 31929 9



0635-3703